



## Tottenham Lane, N8

£550,000

A spacious ground floor flat with a large open plan reception room and kitchen and two double bedrooms. The property features both a family bathroom and en-suite in the primary bedroom. The flat also benefits from a concierge service, shared gardens, a communal gym and allocated gated off-street parking.

Ideally positioned for an array of desirable amenities and green spaces, including Crouch End Broadway, Hornsey High Street and Alexandra Palace. Well connected via mainline train services from Hornsey and multiple bus routes into Central London.

### Features

- Two Bedroom
- Chain Free
- Open Plan Reception
- Communal Gym
- Allocated Parking
- Concierge Serviced Building

# Tottenham Lane, London, N8

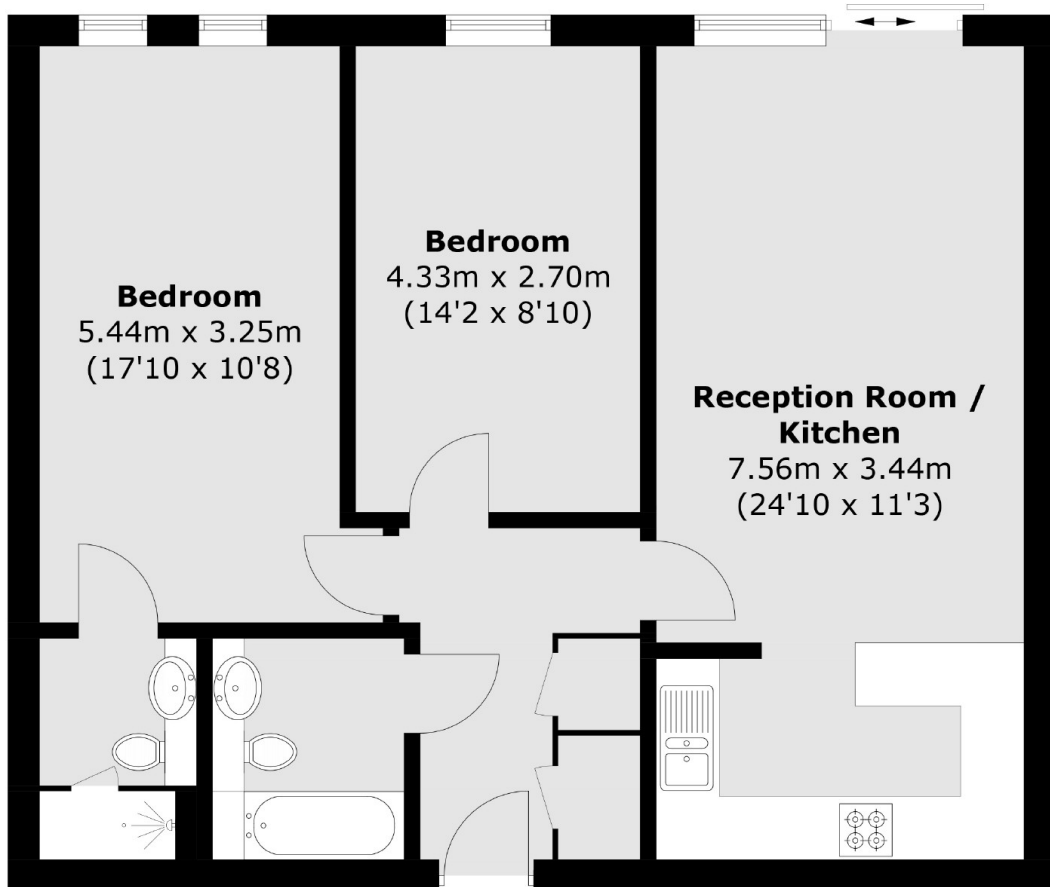

Total area (approx.): 72.5 sq. m (780.4 sq. ft)