

Tiltman Place, N7

£395,000

A bright and spacious one bedroom apartment located in a private development. This residence features an open plan living area, a generously sized double bedroom with built in wardrobes, bathroom and wooden flooring throughout.

Tiltman Place is well located between Finsbury Park, Archway and Tufnell Park. Offering easy access to the fantastic range of local shops, restaurants, coffee shops and eateries situated along the popular Stroud Green Road and surrounding area. The Victoria & Piccadilly Underground Lines, London Overground, Thameslink and the Great Northern City Line are all accessible from the nearby Finsbury Park station.

Features

- One Bedroom
- Open Plan
- Balcony
- Private Development
- 24 Hour Concierge
- Chain Free

Tiltman Place, London, N7

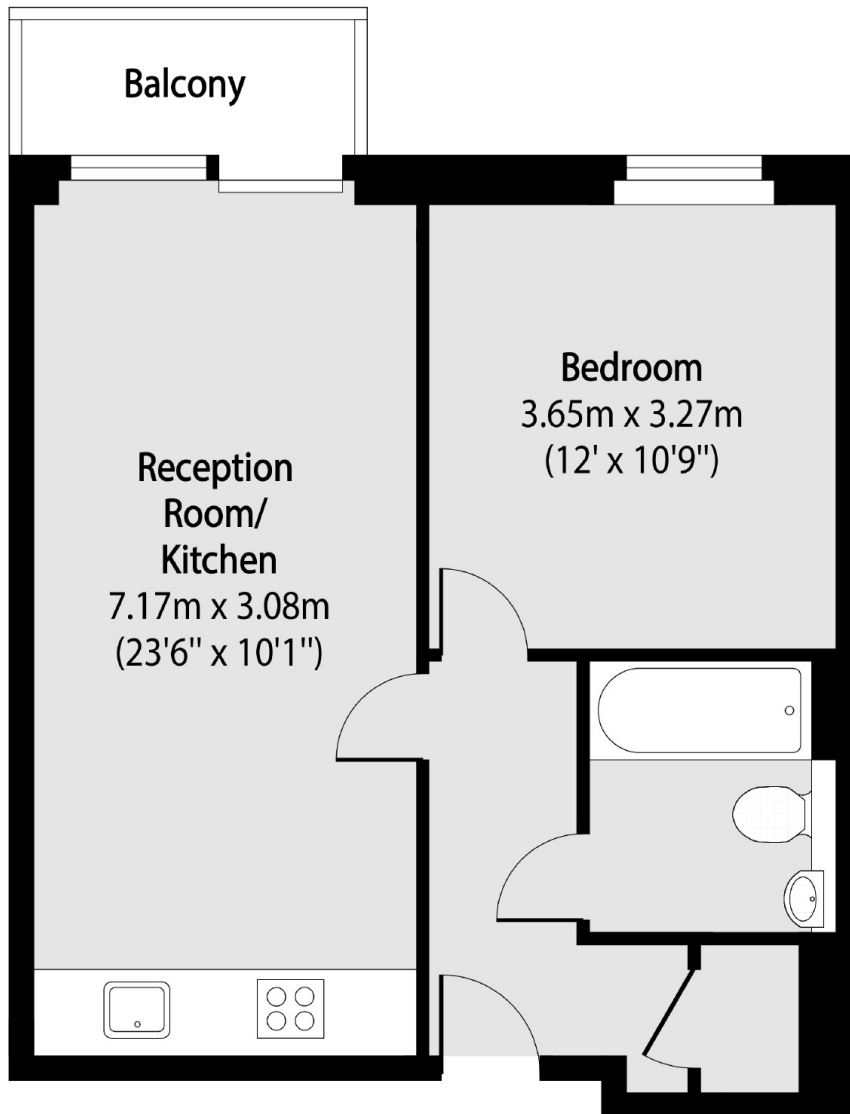

Total area (approx): 45.43 sq m (489 sq. ft)

Balcony total area (approx): 2.97 sq m (32 sq. ft)