

Woodstock Road, N4

£500,000

Situated on the ground floor of a converted Victorian building is this one bedroom garden flat in the heart of Stroud Green. Presented in good decorative order throughout, the property features an open plan kitchen reception area, ample storage and a large private rear garden.

Woodstock Road is a quiet, residential turning, perfectly positioned close to Finsbury Park station (Great Northern, Thameslink, Victoria and Piccadilly lines) as well a plethora of independent shops, bars, pubs, restaurants and cafés. This property is also located minutes away from the popular Parkland Walk Nature Reserve.

Features

- Period Conversion
- One Bedrooms
- Open Plan Kitchen
- Private Garden
- Chain Free
- Excellent Transport Links

Woodstock Road, London, N4

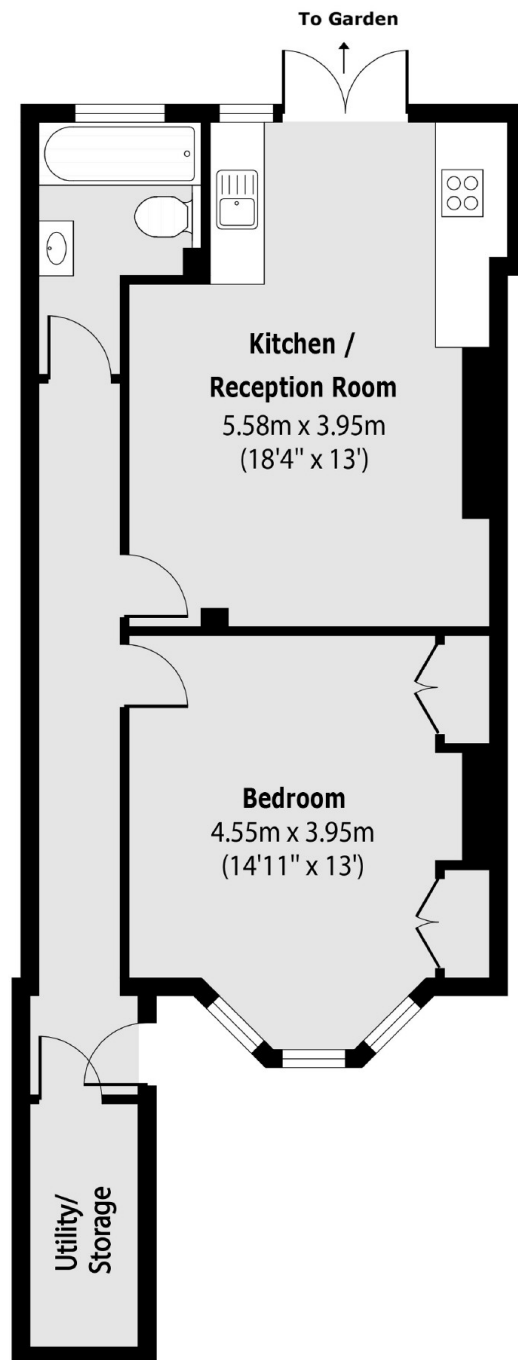

Total area (approx): 54.06 sq m (582 sq. ft)