



Grenville Road, N19

£475,000

A spacious first-floor flat measuring over 550 sq.ft. This charming property features a generous reception room, a separate kitchen, two double bedrooms, and a modern bathroom. With high ceilings and ample storage, the flat is offered to the market chain-free.

Grenville Road is perfectly positioned for the borders of Crouch End and Stroud Green, offering access to nearby transport links and amenities of Crouch End and Crouch Hill, Stroud Green and Finsbury Park. The shops, bars, restaurants and coffee shops are also within easy reach of the flat.

Features

- Newly Refurbished
- Two Bedroom
- Great Transport Links
- Share of Freehold
- Chain Free
- Communal Bike Shed

Grenville Road, London, N19

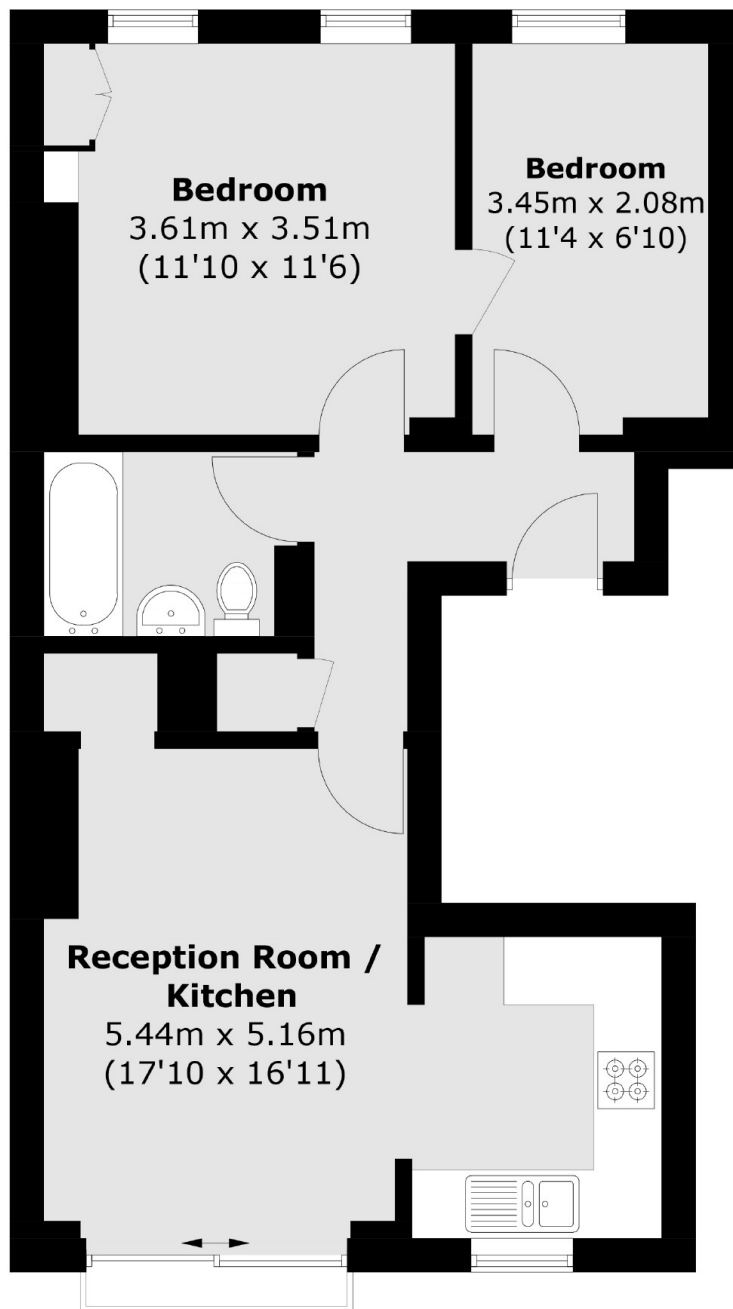

Total area (approx.): 51.5 sq. m (554.3 sq. ft)