



Portland Rise, N4

£375,000

A well-presented one-bedroom ground floor flat in an attractive Victorian building. The property features wooden flooring, natural light, and high ceilings throughout. It offers an open-plan reception/kitchen area and a modern bathroom.

Portland Rise is located close to Finsbury Park Station (Great Northern, Thameslink, Victoria and Piccadilly Lines) as well as an array of independent shops, bars, restaurants and cafés. The property is a short walk away from the green open spaces of Finsbury Park, Clissold Park and Woodberry Wetland nature reserve.

Features

- One Bedroom
- High Ceilings
- Open Plan Kitchen/Dining
- Share of Freehold
- Excellent Transport Links
- Chain Free

Portland Rise, London, N4

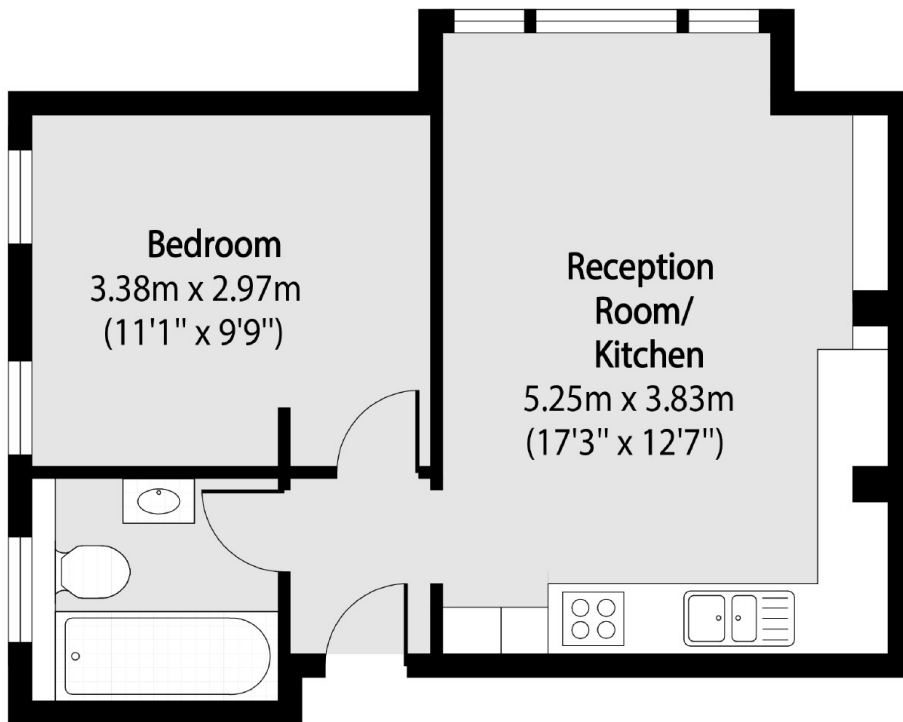

Total area (approx): 36.38 sq m (392 sq. ft)