

Hillfield Avenue, N8

£425,000

A spacious two double bedroom flat with an open plan reception/kitchen area with large sash windows, allowing for lots of natural light. The property has ample storage throughout and has a private parking space.

Ideally located in the heart of Crouch End, offering a wide array of shops, restaurants and cafés, and just moments away from excellent transport links, with local bus routes providing direct access to Finsbury Park station.

Features

- Two Bedrooms
- Open Plan Living
- Leasehold
- Great Transport Links
- Private Parking
- Residential Road

Hillfield Avenue, London, N8

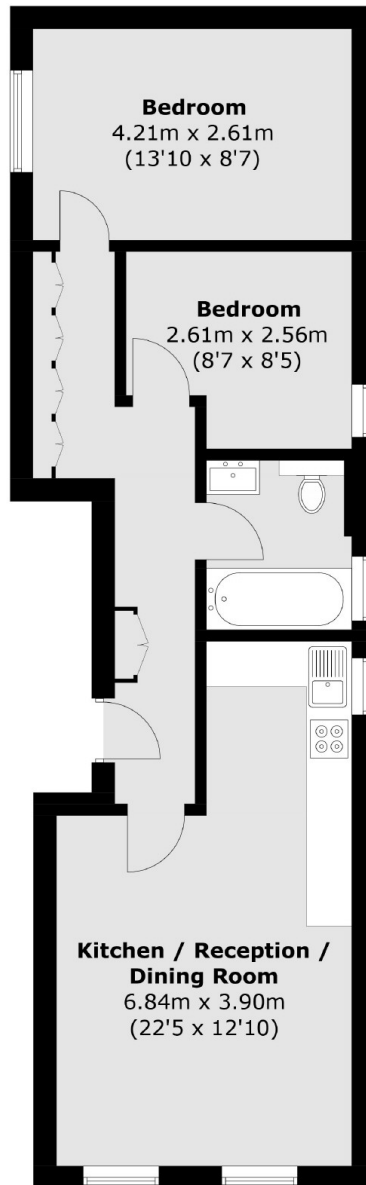

Total area (approx.): 57.1 sq. m (614.6 sq. ft)
(Excluding Eaves)