



Allison Road, N8

£600 Per week

A two double bedroom property on Harringay Ladder. This property is almost 900 sq ft and benefits from a great open plan living area that leads directly onto a private garden. There is also two double bedrooms and a family bathroom.

Allison Road is situated within the Harringay Ladder and is close to a selection of local restaurants, coffee shops and eateries the local area has to offer. Turnpike Lane Underground Tube Station and Harringay overground Station are nearby as are the green open spaces of Ducketts Common and Finsbury Park.

Features

- Period Conversion
- Two Double Bedrooms
- Open Plan
- Private Garden
- Great Location
- Great Transport Links

Allison Road,
London, N8

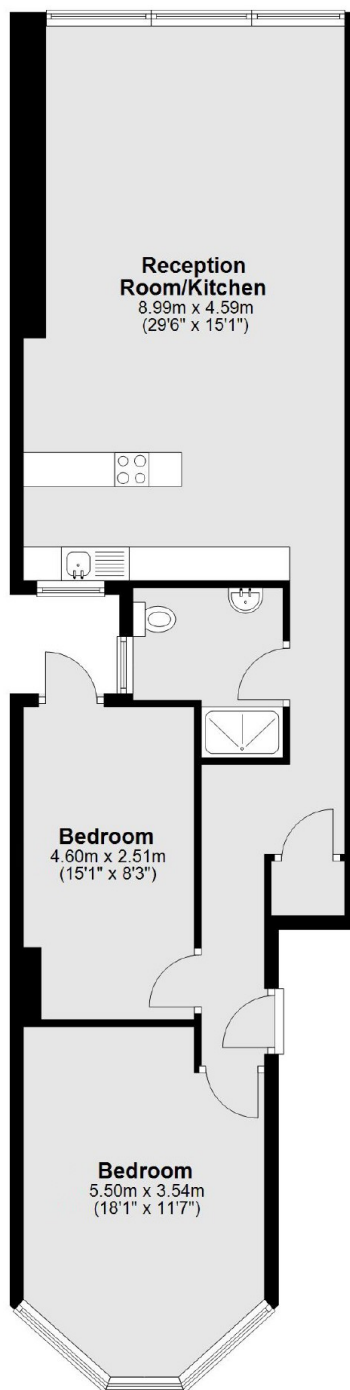

Total area: approx. 81.3 sq. metres (875.3 sq. feet)