



## Mary Neuner Road, N8

£650,000

A stunning two-bedroom, contemporary apartment in one of North London's most exciting new development. This apartment features an open-plan kitchen and reception area with direct access to a large private balcony, two double bedrooms (including an en-suite master) and ample storage. The property also has a secure underground parking space as well as access to a state-of-the-art gym, swimming pool, steam room, sauna, and treatment area.

There are four stations all within a 13 min walk providing access via the Underground to King's Cross St Pancras in just 14 minutes and via the Overground to Moorgate in the heart of the City in 20 minutes.

### Features

- Two Double Bedrooms
- Wheel Chair Accessible
- Private Balcony
- 24hr Concierge
- Residents Lounge
- Parking

# Mary Neuner Road, London, N8

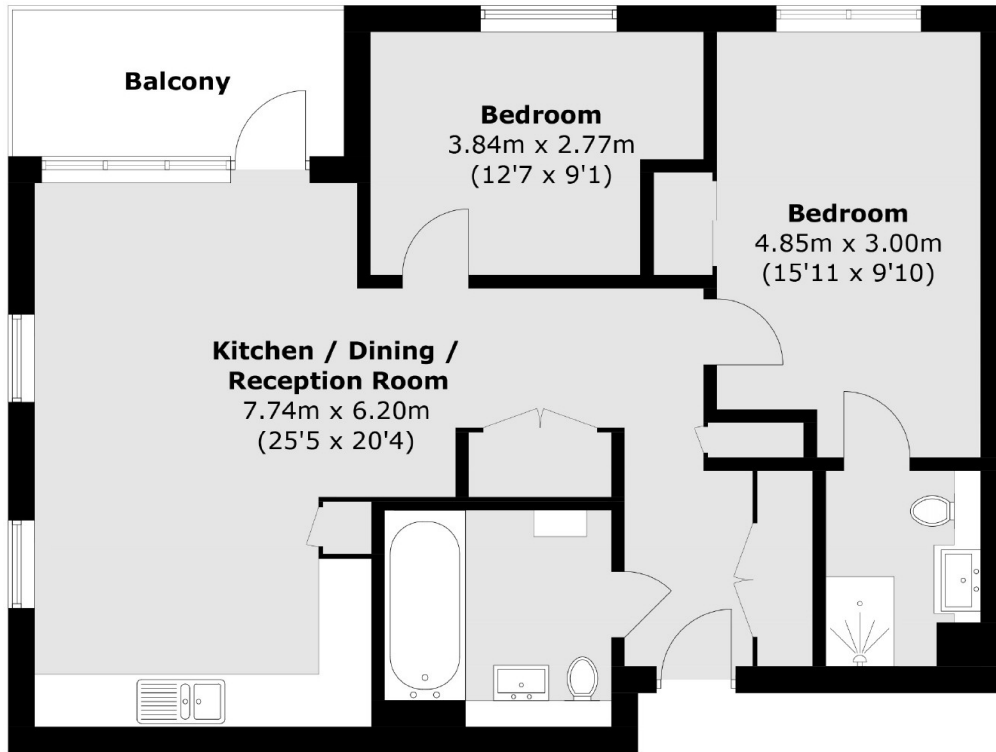

Total area (approx.): 76.4 sq. m (823.1 sq. ft)  
Balcony: 7.9 sq. m (85.2 sq. ft)