



Stroud Green Road, N4

£508 Per week

A newly refurbished two bedroom flat on Stroud green road. Located on the first floor, the flat has a spacious open plan kitchen diner with two double bedrooms and contemporary bathroom suite with shower over bath.

Stroud Green Road is well situated for local shopping and has a wide variety of restaurants, cafés and supermarkets. Finsbury Park station is within walking distance for access to underground and mainland services.

Features

- Newly Refurbished
- First Floor
- Open Plan Reception
- Two Double Bedrooms
- Great Location
- Close To Finsbury Park Station

Stroud Green Road,
London, N4

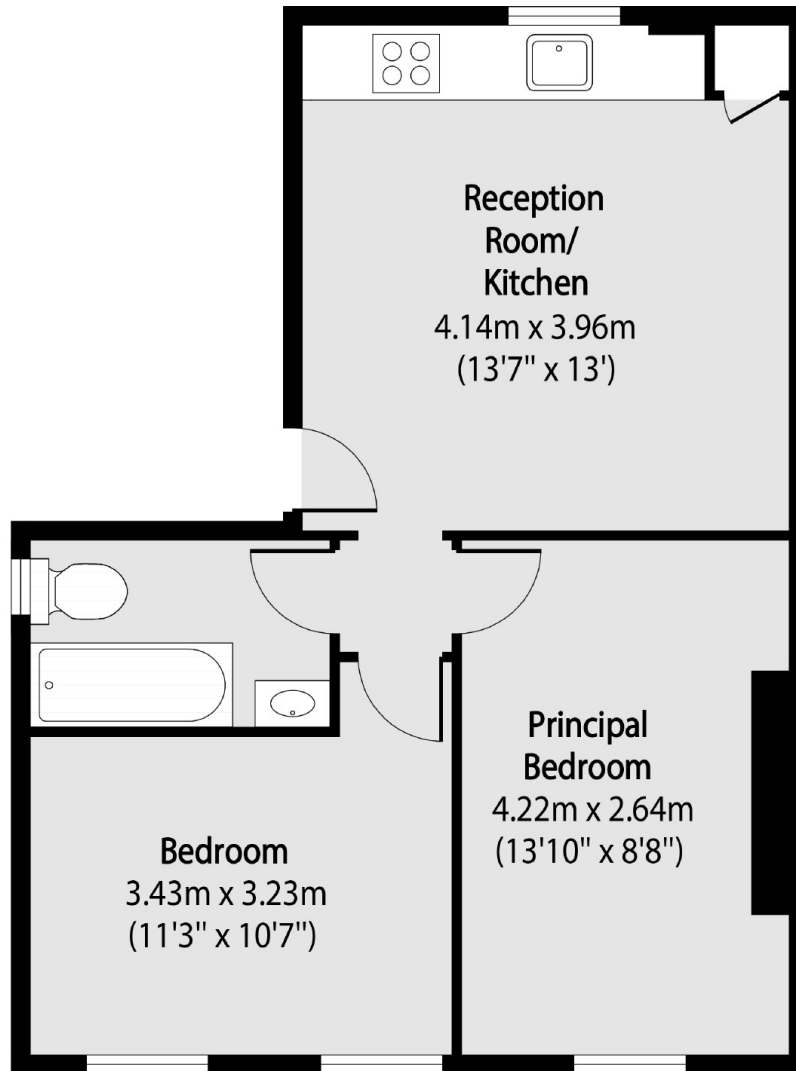

Total area (approx): 42.46 sq m (457 sq. ft)