



Tollington Park, N4

£375 Per week

A well presented one bedroom apartment on the third floor of a small private, well run block just a short walk from Finsbury Park underground tube station and National Rail services.

The flat has the benefit of a communal garden as well as being close to the open spaces of Finsbury Park and the nearby shops, bars and restaurants and pubs along Stroud Green.

Features

- One Bedroom
- Second Floor
- Private Block
- Great Location
- Close To Transport Links
- Communal Garden

Tollington Park, London, N4

Third Floor

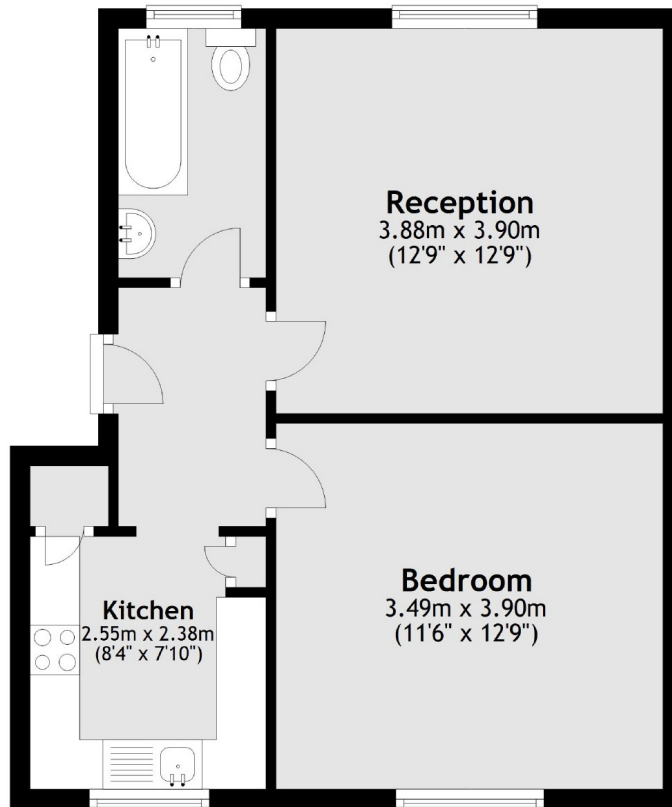

Total area: approx. 44.9 sq. metres (483.1 sq. feet)