



Blackstock Road, N4

£575,000

This well presented two double bedroom first floor conversion flat offers high ceilings with large windows, an open plan kitchen / living area and is offered on the market in amazing decorative order.

Blackstock Road is perfectly positioned for easy access to the green open spaces of Finsbury Park, Clissold Park and Woodberry Wetland nature reserve. A vast array of shops, cafés and restaurants are located nearby. Finsbury Park station is 0.5 miles away with easy access to central London, and direct trains to Heathrow and Gatwick Airports.

Features

Two Double Bedrooms
Ready to move into
Open Plan Kitchen/Living
Long Lease
Amazing transport Links

Blackstock Road, London, N4

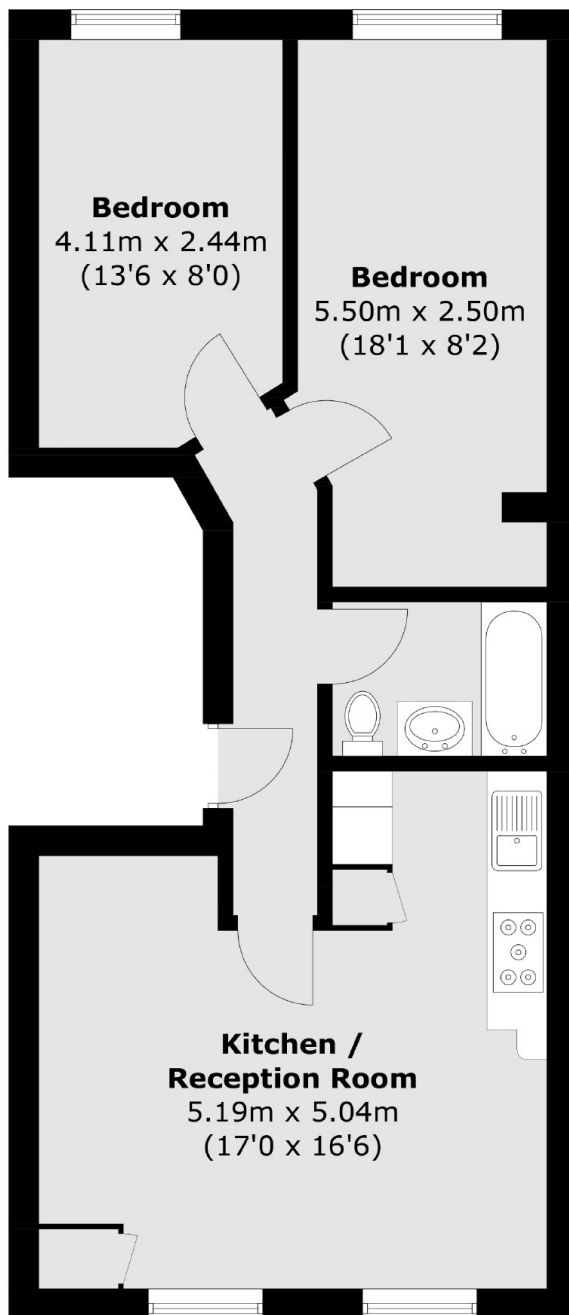

Total area (approx.): 56.3 sq. m (606.0 sq. ft)