



Thorpedale Road, N4

£325,000

Situated on the first floor of a popular purpose-built development is this one-double-bedroom apartment. Spanning over 460 sq.ft in size, the bright accommodation offers a separate fully-fitted kitchen, separate living room and double-glazed windows throughout.

Situated on a quiet street next to Wray Crescent park and within easy walking distance of Stroud Green and Finsbury Park's shopping amenities and transport links.

Features

- Chain Free
- Purpose Built
- Spacious One Bedroom
- Leasehold
- Separate Kitchen
- Excellent Transport Links

Thorpedale Road, London, N4

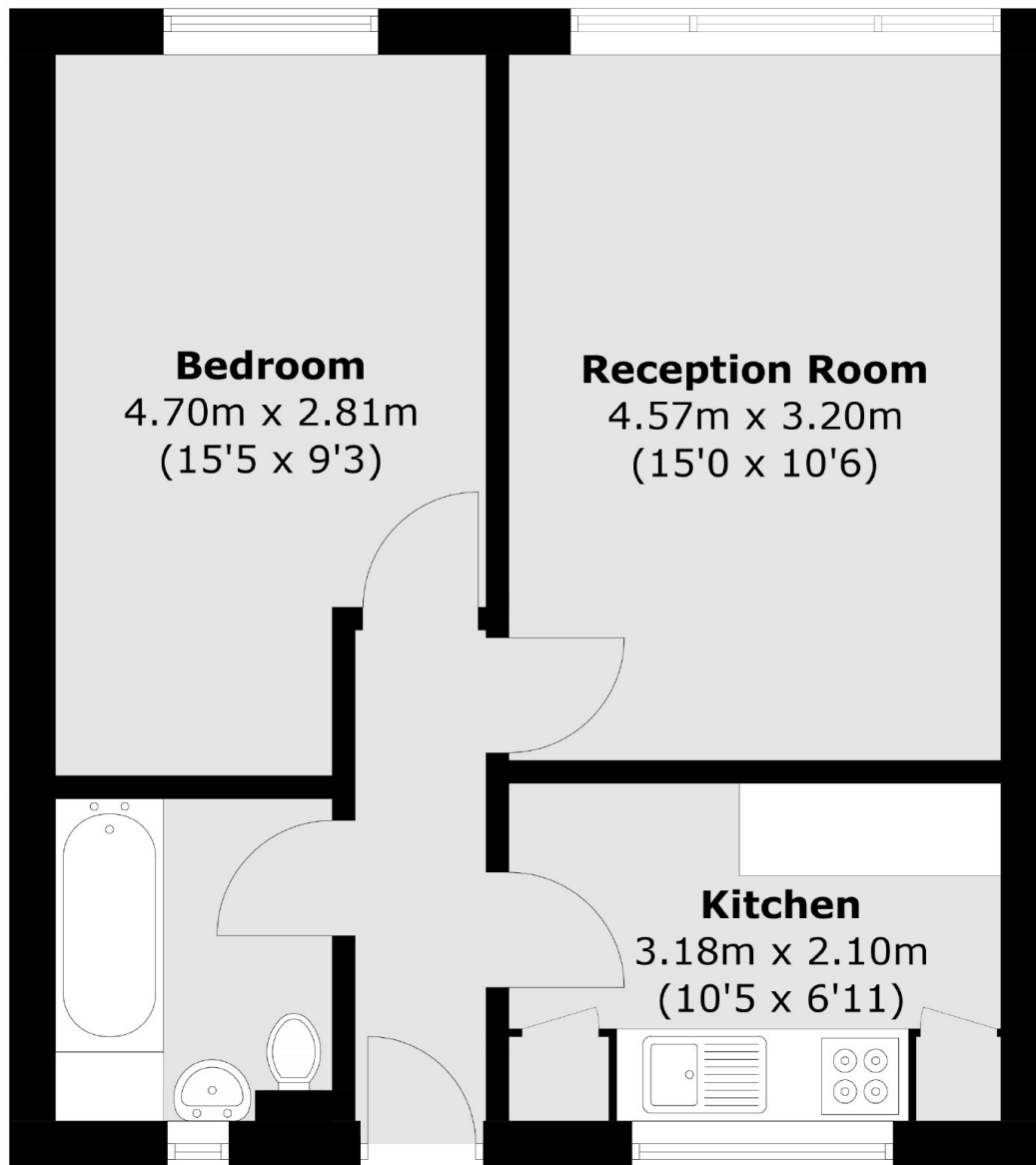

Total area (approx.): 42.9 sq. m (461.8 sq. ft)