



Rathcoole Gardens, N8

£689,500

An attractive two double bedroom split level period conversion, spanning over 600 sq.ft. The property offers a spacious reception room, a separate kitchen, sizeable private rear garden. Further benefits are high ceilings, bay windows, a decorative fireplace and a cloakroom W.C.

Rathcoole Gardens is located on a quiet tree lined residential turning within walking distance to Crouch End Broadway, which offers an array of shops, bars, restaurants and independent cafés. Hornsey Station is also accessible on foot, providing direct links to Finsbury Park Station and beyond. Weston Park Primary School (Ofsted rated) and Rokesly Primary School are also located close by.

Features

- Private Rear Garden
- End of Terrace
- Period Conversion
- Two Double Bedrooms
- Separate Reception Room
- Freehold

Rathcoole Gardens, London, N8

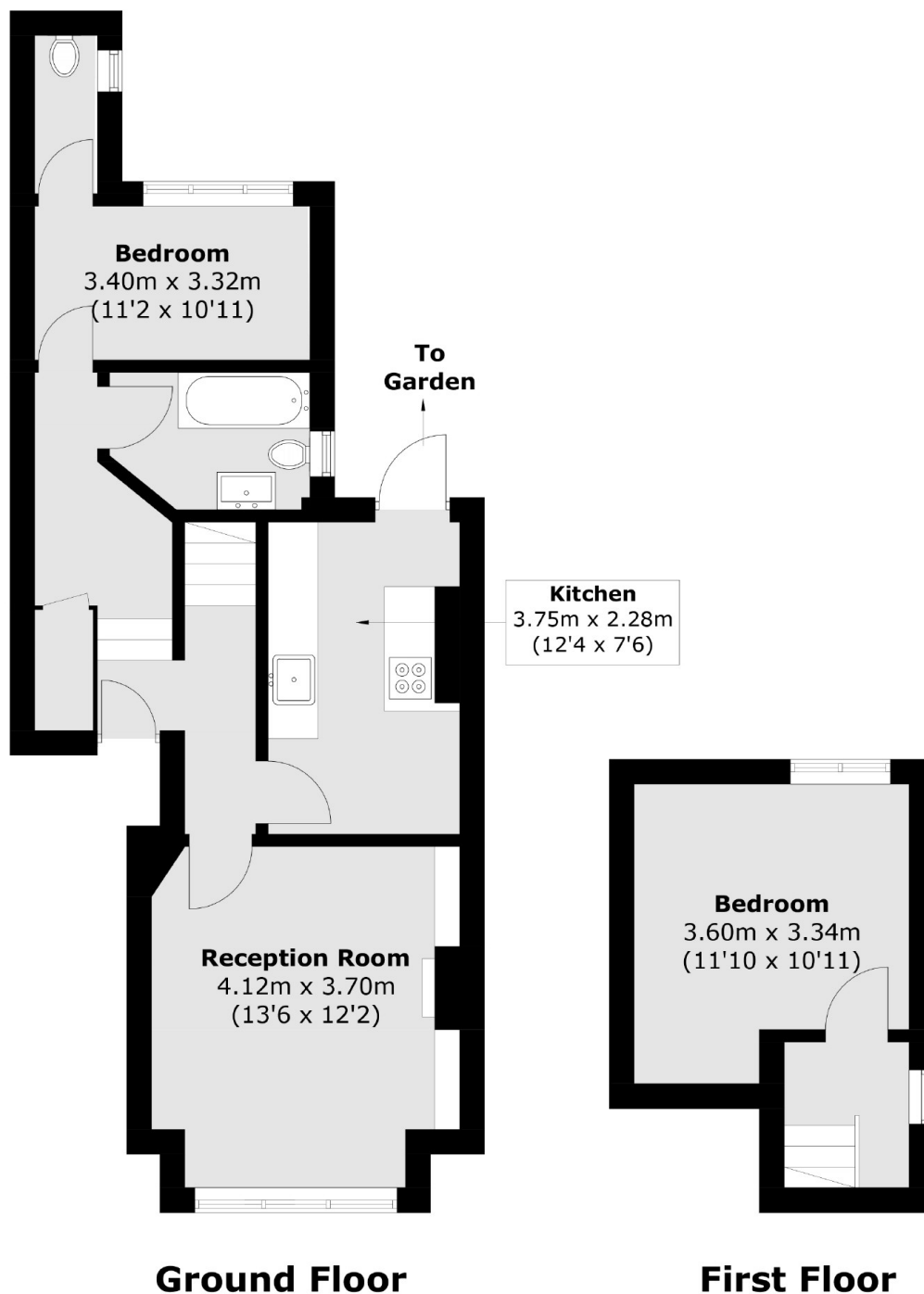

Total area (approx.): 59.8 sq. m (643.7 sq. ft)