



Tiltman Place, N7

£500,000

A apartment that has two double bedrooms and is in a modern safe development. This property has an open-plan kitchen leading onto a private balcony, a large master bedroom with an en suite, a double second bedroom and a family bathroom.

Tiltman Place is well located between Finsbury Park, Archway and Tufnell Park. Offering easy access to the fantastic range of local shops, restaurants, coffee shops and eateries situated along the popular Stroud Green Road and surrounding area. The Victoria & Piccadilly Underground Lines, London Overground, Thameslink and the Great Northern City Line are all accessible from the nearby Finsbury Park station.

Features

- Balcony
- Lift access
- Open Plan Kitchen
- En Suite
- 24 Hour Security / Concierge
- Private Parking Space

Tiltman Place, London, N7

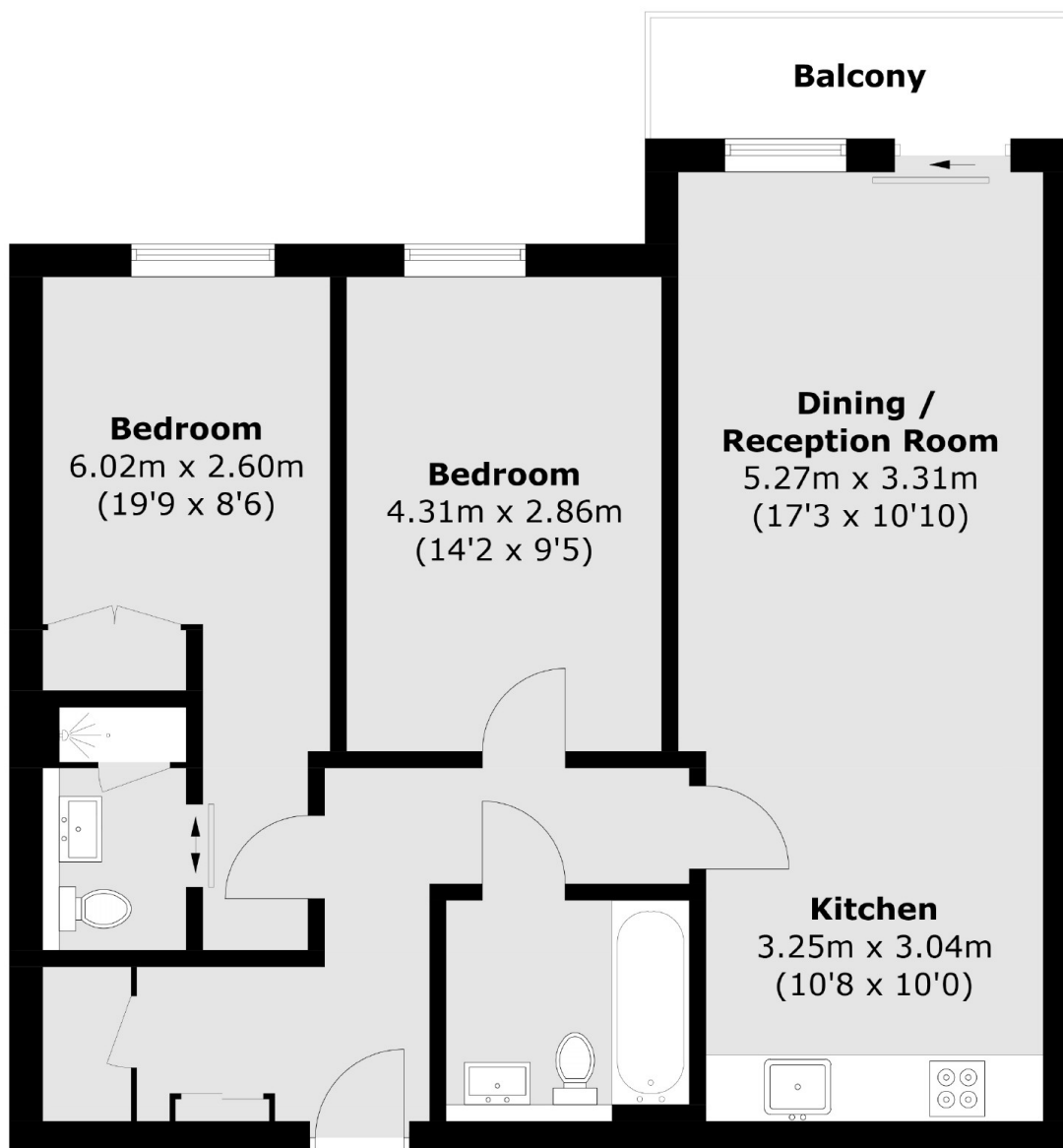

Total area (approx.): 72.7 sq. m (782.5 sq. ft)
Balcony: 4.2 sq. m (45.2 sq. ft)