



## 164 Banks Road, Wirral, CH48 0RH £450



Rooms Available

This space is perfect for small and large businesses looking for a base without the expensive overheads of a standalone commercial.

Viewing is essential to appreciate the set up of the centre, there are currently a mix of businesses working from the centre and benefitting from the facilities.

There are a number of rooms available priced between £450 to £675 per month. Viewing is recommended to appreciate the size and location of each room.

- Newly Refurbished Offices
- Private Lockable Glass Offices
- Shared Amenities
- 24HR Surveillance And Monitored Intruder Alarm
- Utilities Included
- Sought After Location
- Busy High Street
- Viewing Essential!



### Viewing

To arrange a viewing on this property or require further information please contact one of our team on 0151 638 6313



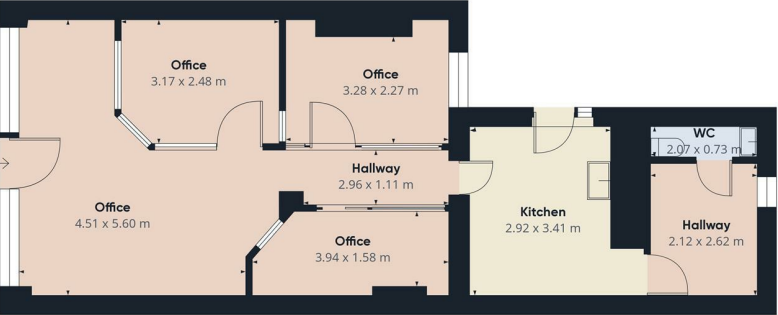

Approximate total area\*  
63.55 m<sup>2</sup>

(1) Excluding balconies and terraces.

While every attempt has been made to ensure accuracy, all measurements are approximate, not to scale. This floor plan is for illustrative purposes only. Calculations are based on RICS IPMS 3C standard.

GRAFFI 360



Energy Efficiency Rating		
	Current	Potential
Very energy efficient - lower running costs		
(92 plus) A		
(81-91) B		
(69-80) C		
(55-68) D		
(39-54) E		
(21-38) F		
(1-20) G		
Not energy efficient - higher running costs		
England & Wales		
EU Directive 2002/91/EC		



These particulars, whilst believed to be accurate are set out as a general outline only for guidance and do not constitute any part of an offer or contract. Intending purchasers should not rely on them as statements of representation of fact, but must satisfy themselves by inspection or otherwise as to their accuracy. No person in this firms employment has the authority to make or give any representation or warranty in respect of the property.

93-95 Wallasey Road, Wallasey, Merseyside, CH44 2AQ  
T. 0151 638 6313 | E. sales@bakewellhorner.co.uk  
<https://www.bakewellhorner.co.uk/>