



Galpins Road Thornton Heath CR7

AUCTION GUIDE PRICE

£370,000-£390,000

Lovely three bedroom family home with thru lounge has a fitted open plan kitchen, large rear garden, off street parking, gas central heating, double glazing and more, vacant possession

EPC Rating C

Council tax band D

Galpins Road

Galpins Road Thornton Heath

Bedroom 1 14'1" x 10'2" (4.30 x 3.10)

Hall



Lounge/diner 26'10" x 10'2" (8.20 x 3.10)



Bedroom 12'5" x 10'2" (3.80 x 3.10)



Kitchen 8'10" x 5'10" (2.70 x 1.80)



Bedroom 3 7'6" x 5'10" (2.30 x 1.80)



Galpins Road

Buyers Guide

Bathroom 7'6" x 5'10" (2.30 x 1.80)



Garden 72'2" x 17'4" (22 x 5.30)



Lounge second aspect



Back





GARDEN
(APPROX)
22 M X 5.3 M



GROUND FLOOR
448 sq.ft. (41.6 sq.m.) approx.

1ST FLOOR
424 sq.ft. (39.4 sq.m.) approx.

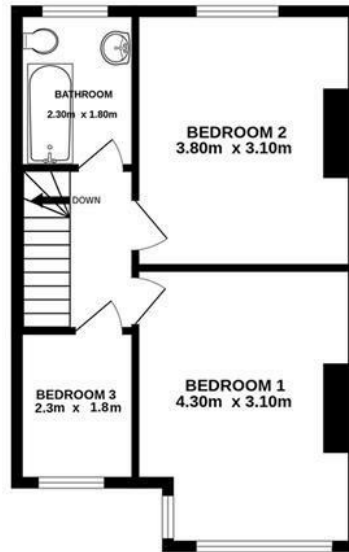
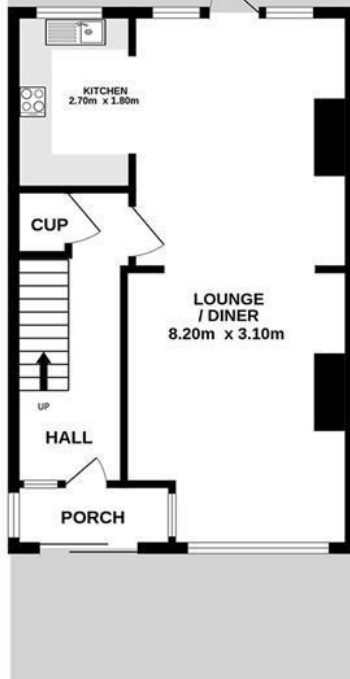

TOTAL FLOOR AREA : 872 sq.ft. (81.0 sq.m.) approx.

Energy Efficiency Rating

	Current	Potential
<i>Very energy efficient - lower running costs</i>		
(92 plus) A		88
(81-91) B		
(69-80) C	71	
(55-68) D		
(39-54) E		
(21-38) F		
(1-20) G		
<i>Not energy efficient - higher running costs</i>		
England & Wales	EU Directive 2002/91/EC	

