

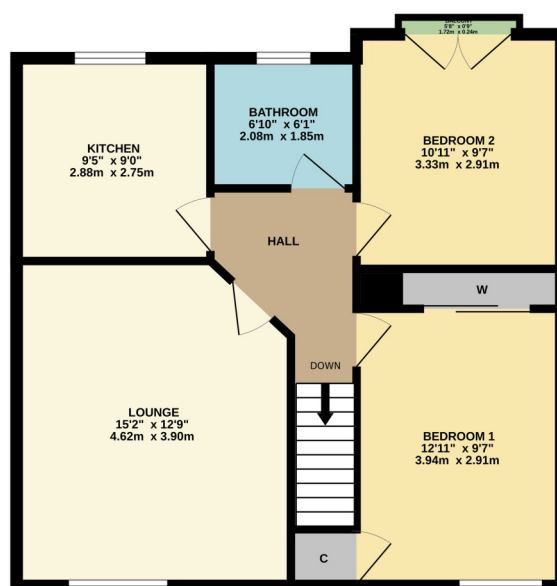

9 Oakburn Gardens, Jamestown, G83 9NN

This seldom available modern two-bedroom first floor flat is presented to the market in true walk-in condition. This immaculate property is situated in the desirable, select and private Oakburn Gardens development and will be of interest to a wide range of buyers including young couples, downsizers and first-time buyers.

FIRST FLOOR



TWO BEDROOM UPPER COTTAGE FLAT

While every attempt has been made to ensure the accuracy of the description contained here, measurements of doors, windows, rooms and any other items are approximate and no responsibility is taken for any error, omission or misstatement. This plan is for illustrative purposes only and should be used as such by any prospective purchaser. The services, systems and appliances shown have not been tested and no guarantee as to their quality or efficiency can be given.
Made with MetreX 12/2025



David Muir Estate Agents
2 Church Street, Dumbarton,
G82 1QL



Tel 01389 734366
Fax 01389 742476



tracy@davidmuirestates.co.uk



davidmuirestates.com



davidmuirestates

Travel Directions

From Bonhill bridge head towards Dumbarton, At the first roundabout take the first exit onto Nobleston and head up the hill, take the first right onto Beechwood Drive, second right onto Murroch Crescent.

Additional Information

Home Report Valuation: £130,000
Asking Price: Offers Over £128,000
Council Tax Band: C
Energy Efficiency Rating: C
Double Glazing
Gas Central Heating

Home Report

This property benefits from a Home Report which can be obtained from davidmuirestates.com or onesurvey.org

Disclaimer

These property details are set out as a general outline only and do not constitute any part of an Offer or Contract. All fixtures and fittings mentioned in these particulars are included in the sale. All others in the property are specifically excluded. Photographs are reproduced for general information and it must not be inferred that any item is included for sale with the property. All measurements, distances and areas are approximate and for guidance only.