

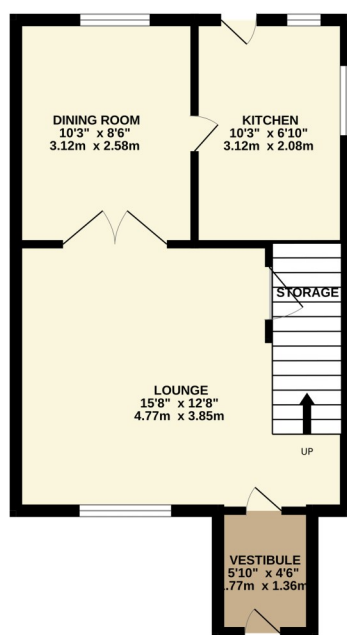

10 Meadow Court, Dumbarton, G82 3BZ

David Muir Estate Agents offer to the market this well-presented 3 bedroom semi-detached villa, which is located in this popular residential estate, within walking distance to the town centre, sports facilities, schools and public transport links.

GROUND FLOOR
390 sq.ft. (36.2 sq.m.) approx.



1ST FLOOR
364 sq.ft. (33.8 sq.m.) approx.

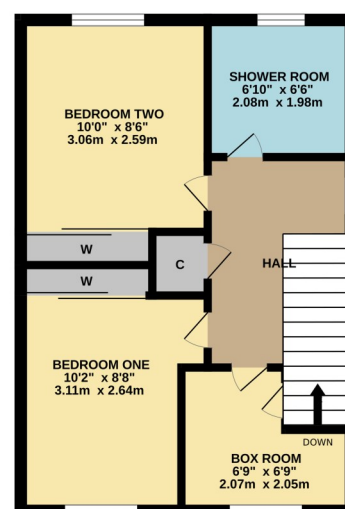

TOTAL FLOOR AREA: 754 sq.ft. (70.0 sq.m.) approx.

Whilst every attempt has been made to ensure the accuracy of the floorplan contained here, measurements of doors, windows, rooms and any other items are approximate and no responsibility is taken for any error, omission or mis-statement. This plan is for illustrative purposes only and should be used as such by any prospective purchaser. The services, systems and appliances shown have not been tested and no guarantee as to their operability or efficiency can be given.

Made with Metropix ©2025



David Muir Estate Agents
2 Church Street, Dumbarton,
G82 1QL



Tel 01389 734366
Fax 01389 742476



tracy@davidmuirestates.co.uk



davidmuirestates.com



davidmuirestates

Travel Directions

From agents office in Church Street proceed to roundabout. Take 2nd exit, under railway Station Bridge and third left into Park Crescent. Turn right at Golf Club entrance and first left into Meadow Court. No 10s on your right.

Additional Information

Home Report Valuation: £185,000
Asking Price: Offers Over £180,000
Council Tax Band: C
Energy Efficiency Rating: C
Double Glazing
Gas Central Heating

Home Report

This property benefits from a Home Report which can be obtained from davidmuirestates.com or onesurvey.org

Disclaimer

These property details are set out as a general outline only and do not constitute any part of an Offer or Contract. All fixtures and fittings mentioned in these particulars are included in the sale. All others in the property are specifically excluded. Photographs are reproduced for general information and it must not be inferred that any item is included for sale with the property. All measurements, distances and areas are approximate and for guidance only.