

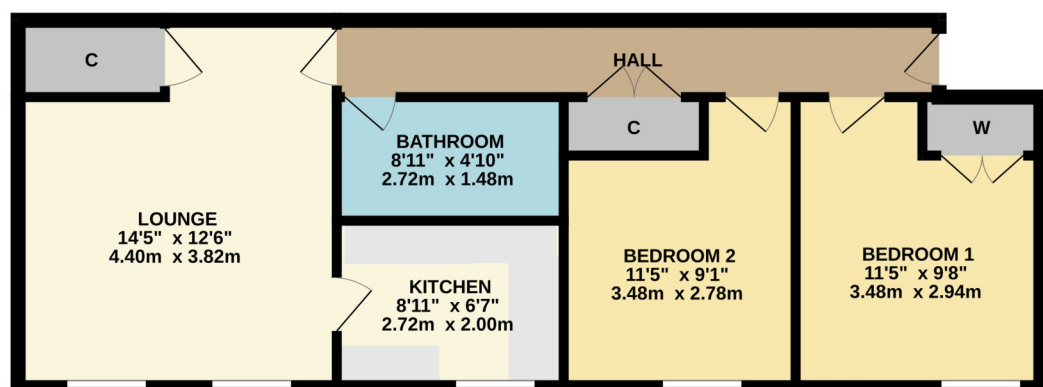

No 2, Flat 9 Riverside Court, Balloch, G83 8LN

David Muir Estate Agents offer to the market this two-bedroom second floor flat which is conveniently located within walking distance to shops, schools and Balloch train station.

SECOND FLOOR



TWO BEDROOM FLAT

Whilst every attempt has been made to ensure the accuracy of the floorplan contained here, measurements of doors, windows, rooms and any other items are approximate and no responsibility is taken for any error, omission or mis-statement. This plan is for illustrative purposes only and should be used as such by any prospective purchaser. The services, systems and appliances shown have not been tested and no guarantee as to their operability or efficiency can be given.
Made with Metropix ©2025



David Muir Estate Agents
2 Church Street, Dumbarton,
G82 1QL



Tel 01389 734366
Fax 01389 742476



tracy@davidmuirestates.co.uk



davidmuirestates.com



davidmuirestates

Travel Directions

From Balloch Railway station turn left up hill on Tullichewan Road. Turn left into Lomond Road and continue over Leven Bridge. Turn right into Dalvait Road. Continue and as you veer left take right turn into Riverside Court. Parking to your left. Access is at the rear of the building.

Additional Information

Home Report Valuation: £90,000

Asking Price: Offers Over £85,000

Council Tax Band: B

Energy Efficiency Rating: F

Double Glazing

Electric Heating

Home Report

This property benefits from a Home Report which can be obtained from davidmuirestates.com or onesurvey.org

Disclaimer

These property details are set out as a general outline only and do not constitute any part of an Offer or Contract. All fixtures and fittings mentioned in these particulars are included in the sale. All others in the property are specifically excluded. Photographs are reproduced for general information and it must not be inferred that any item is included for sale with the property. All measurements, distances and areas are approximate and for guidance only.