

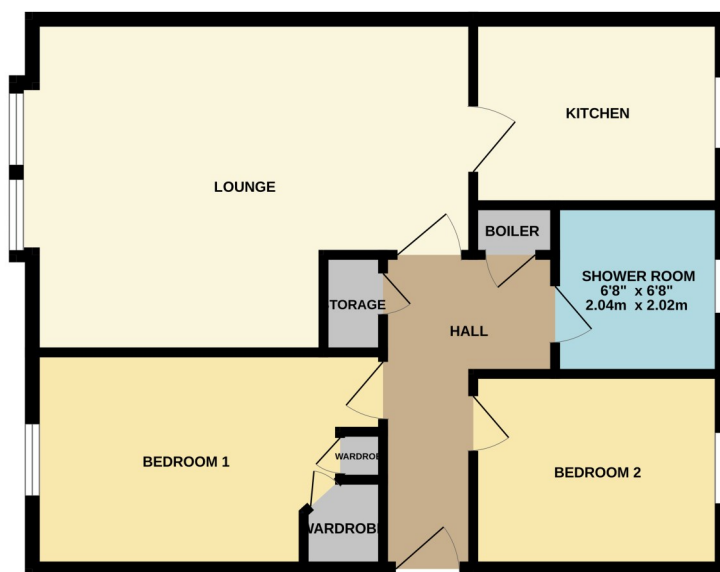

Flat 1, 2 Hartfield Court, Dumbarton, G82 2ET

Located in an extremely central location close to Dumbarton Common, leisure centre, retail outlets and central railway station sits this 2 bedroom ground floor flat. Off street parking for residents and visitors.

GROUND FLOOR



Whilst every attempt has been made to ensure the accuracy of the floorplan contained herein, measurements of doors, windows, rooms and any other items are approximate and no responsibility is taken for any error, omission or mis-statement. This plan is for illustrative purposes only and should be used as such by any prospective purchaser. The services, systems and appliances shown have not been tested and no guarantee as to their operability or efficiency can be given. Made with Metropix ©2024



David Muir Estate Agents
2 Church Street, Dumbarton,
G82 1QL



Tel 01389 734366
Fax 01389 742476



tracy@davidmuirestates.co.uk



davidmuirestates.com



davidmuirestates

Travel Directions

From the agents office on Church Street proceed to the roundabout, take the 3rd exit onto Strathleven Place, continue under the railway bridge onto Bonhill Road, take the first on your right onto Crosslet Road . Then first right into Hartfield Court. No 2 / 1 is second close on your right

Additional Information

Home Report Valuation: £90,000

Asking Price: Offers Over £88,000

Council Tax Band: A

Energy Efficiency Rating: E

Double Glazing

Electric Central Heating

Home Report

This property benefits from a Home Report which can be obtained from davidmuirestates.com or onesurvey.org

Disclaimer

These property details are set out as a general outline only and do not constitute any part of an Offer or Contract. All fixtures and fittings mentioned in these particulars are included in the sale. All others in the property are specifically excluded. Photographs are reproduced for general information and it must not be inferred that any item is included for sale with the property. All measurements, distances and areas are approximate and for guidance only.