

**60 Bonhill Road, Dumbarton, G82 2DY**

Situated in one of Dumbarton's most sought after addresses, this exceptional blonde sandstone semi-detached villa offers generous accommodation together with magnificent, level garden grounds. Bonhill Road is within easy reach of a wide selection of amenities that are found in and around Dumbarton.

GROUND FLOOR  
816 sq.ft. (75.8 sq.m.) approx.

1ST FLOOR  
660 sq.ft. (61.3 sq.m.) approx.

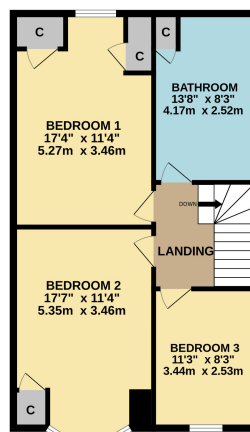
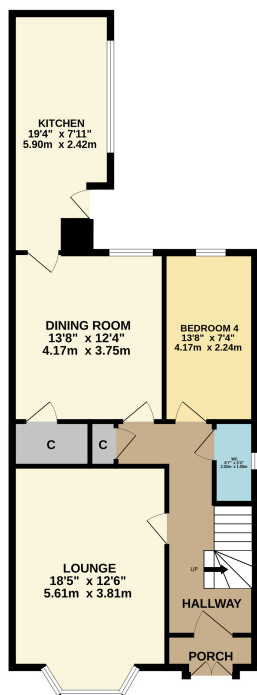

FOUR BEDROOM SEMI-DETACHED VILLA

TOTAL FLOOR AREA: 1476 sq.ft. (137.1 sq.m.) approx.

Whilst every attempt has been made to ensure the accuracy of the floorplan contained here, measurements of floors, windows, rooms and any other items are approximate and no responsibility is taken for any error, omission or mis-statement. This plan is for illustrative purposes only and should be used as such by any prospective purchaser. The price, systems and appliances shown here not been tested and no guarantee as to their operability or efficiency can be given.  
Made with Metropix ©2024



David Muir Estate Agents  
2 Church Street, Dumbarton,  
G82 1QL

Tel 01389 734366  
Fax 01389 742476

tracy@davidmuirestates.co.uk



#### Travel Directions

From the agents office in Church Street proceed to town centre roundabout and take the 3rd exit into Strathleven Place. Continue under bridge into Bonhill Road. No 60 near the north end of Bonhill Road on your right immediately after the junction with Alexander Street.

#### Additional Information

Home Report Valuation: £280,000  
Council Tax Band: F  
Energy Efficiency Rating: D  
Double Glazing  
Gas Central Heating

#### Home Report

This property benefits from a Home Report which can be obtained from [davidmuirestates.com](http://davidmuirestates.com) or [onesurvey.org](http://onesurvey.org)

#### **Disclaimer**

These property details are set out as a general outline only and do not constitute any part of an Offer or Contract. All fixtures and fittings mentioned in these particulars are included in the sale. All others in the property are specifically excluded. Photographs are reproduced for general information and it must not be inferred that any item is included for sale with the property. All measurements, distances and areas are approximate and for guidance only.