

139 Bower Street

, Bedford, MK40 3RA

£380,000



2



1



1



C

Floor Plan

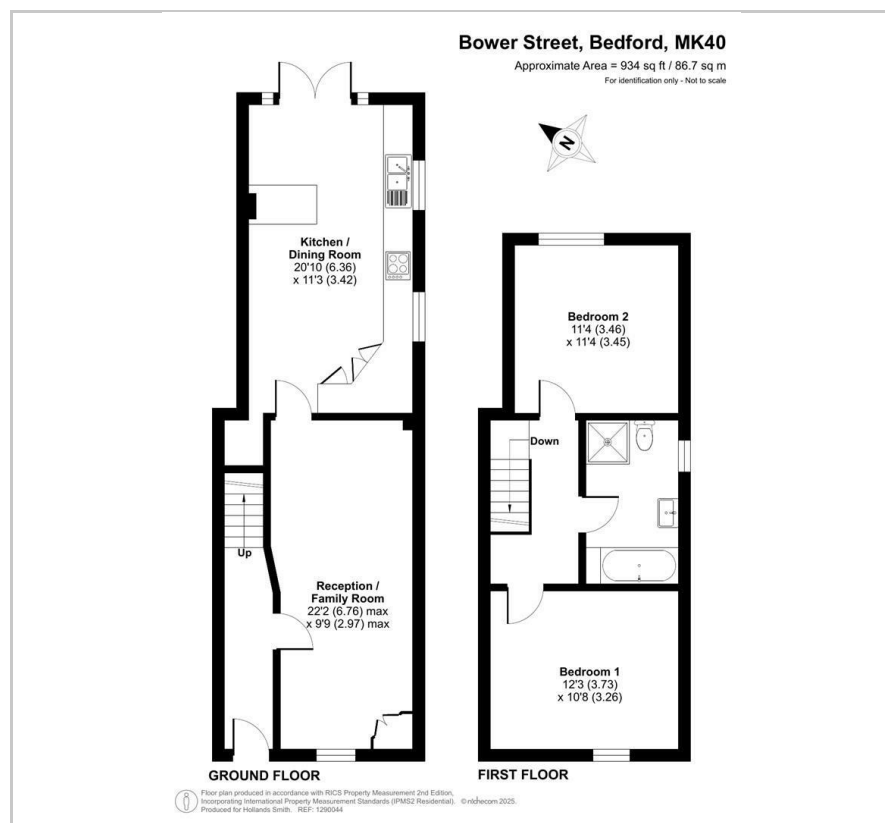

Area Map



Energy Efficiency Graph

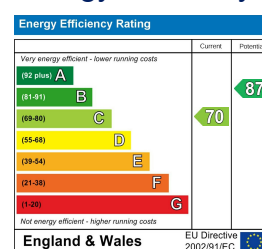

Viewing

Please contact our Bedford Office on 01234 216612 if you wish to arrange a viewing appointment for this property or require further information.

- Fully Renovated, Extended and Refurbished Period Home
- Two Double Bedrooms
- Extensively Fitted Kitchen with Appliances
- Four Piece First Floor Bathroom
- New Fittings, Flooring, Windows & Heating Throughout
- No Upward Chain

Comprehensively refurbished and significantly extended, this period terraced home provides surprisingly spacious accommodation with a high quality, contemporary finish. There are two double bedrooms, a newly installed four piece first floor bathroom and an extensively fitted kitchen/living room, ideal for entertaining. The garden is larger than typical for the area and is not overlooked from the rear. Lying within the heart of the ever popular 'Castle Quarter' the property is within a short walk of a range of amenities. Independent coffee shops, delis and pubs are close at hand with Russell Park and the picturesque Embankment at the end of the street.

EPC Rating: C Council Tax Band: C

Brand new kitchen and bathroom fittings, flooring, heating, windows and decor greet the new owner of this fully renovated period home. The kitchen features integrated appliances to include a dishwasher, washing machine, oven, hob, fridge and freezer as well as underfloor heating. Wide French doors open onto the new patio and lawned garden. Upstairs, there are two comfortably proportioned double bedrooms. The property represents an ideal opportunity for a 'stress free' move and is available with no onward chain.



163 Castle Road, MK40 3RT

Tel: 01234 216612

www.hollandsmith.co.uk