



20 Bushmead Avenue

, Bedford, MK40 3QL

Offers Over £800,000



Floor Plan

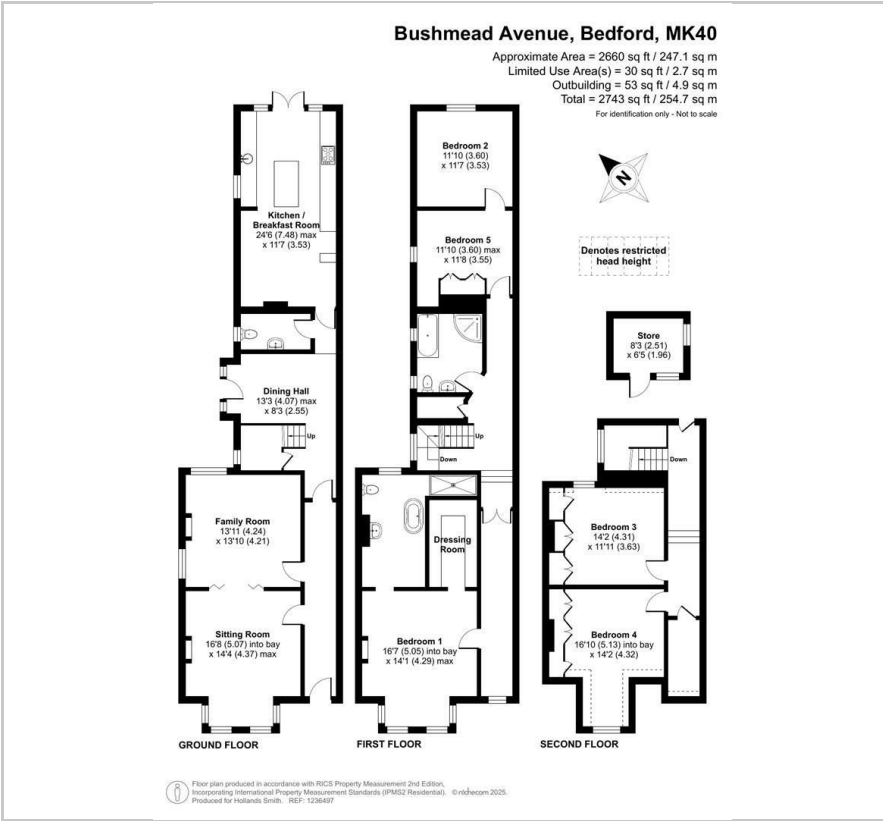

Area Map

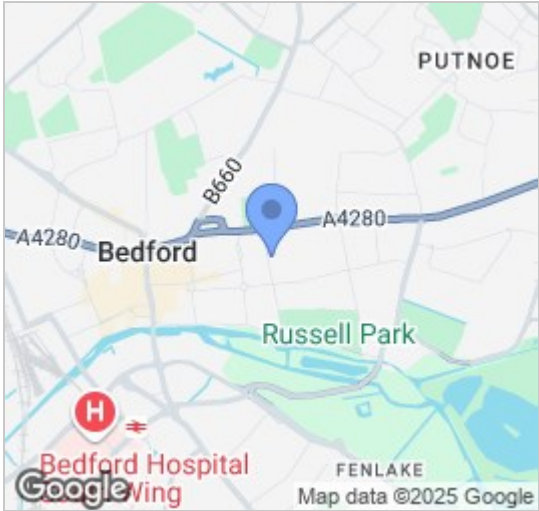

Energy Efficiency Graph

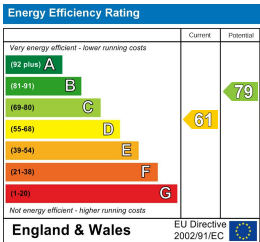

Viewing

Please contact our Bedford Office on 01234 216612 if you wish to arrange a viewing appointment for this property or require further information.



This substantial Victorian villa occupies one the area's most prestigious tree-lined Avenues and provides spacious and adaptable accommodation, arranged over three floors. There are two large self-contained reception rooms separated by folding doors as well as an open plan study or library area and a kitchen/breakfast room with French doors opening to the garden. There are currently five bedrooms, which includes a generous principle suite complete with spacious en suite bathroom and dressing room. To the rear of the first floor there are two connecting bedrooms and a family bathroom and there are two further bedrooms in the second floor along with a large walk-in loft space. Heating is by gas to radiators, the majority of the windows have been replaced with uPVC units including sash style in the front elevation and there are a number of period features throughout the house. Outside, there is a small shared off road parking space to the front and a lawned garden to the rear which is walled all around. In all, this is a rare opportunity to own an impressive period home within easy reach of the wide choice of attractions the town offers.



163 Castle Road, MK40 3RT

Tel: 01234 216612

www.hollandsmith.co.uk

These particulars are believed to be accurate but are not guaranteed to be so. They are intended only as a general guide and cannot be constructed as any form of contract, warranty or offer. No apparatus, equipment, fittings or services have been tested and so we cannot verify that they are in working order. The details are issued on the strict understanding that any negotiations in respect of the property are conducted through Hollands Smith Estate Agents and Valuers.