

11 Beresford Road

, Bedford, MK40 3SD

£395,000



Floor Plan

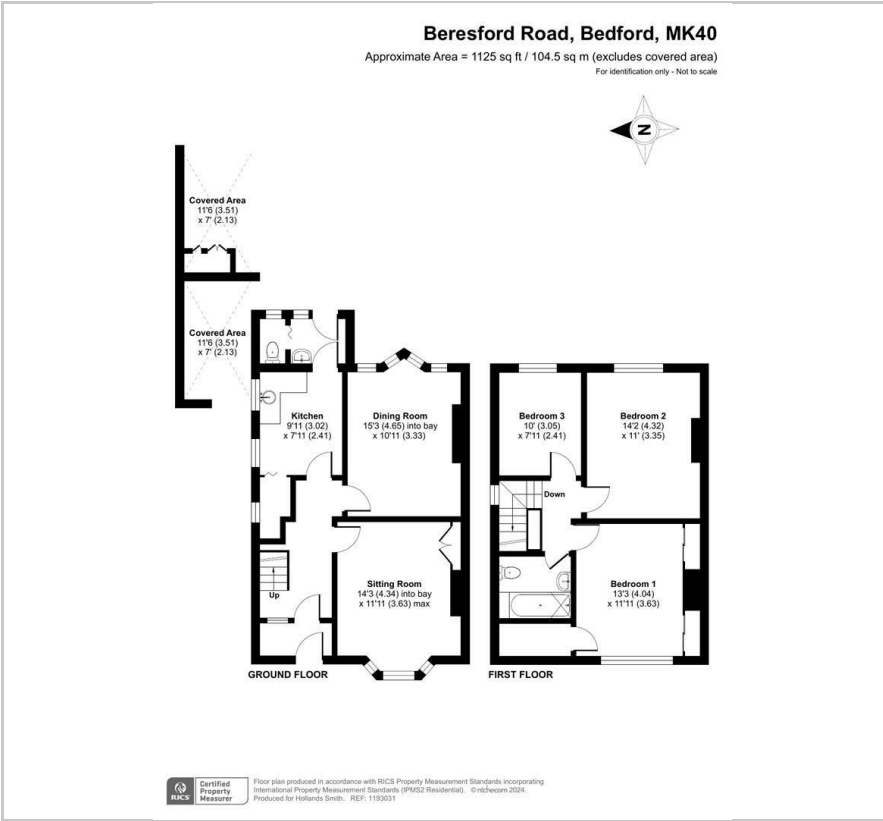

Area Map



Energy Efficiency Graph

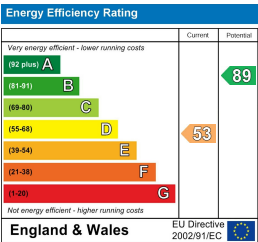

Viewing

Please contact our Bedford Office on 01234 216612 if you wish to arrange a viewing appointment for this property or require further information.



This established semi detached home is available with no upward chain and occupies a quiet cul-de-sac location within the popular Castle Road area, just a short stroll away from Russell Park and The Embankment. Occupied by the same owner for the last 50 years, the property has been well maintained but would now benefit from some general improvement throughout. There are separate sitting and dining room, a kitchen, utility room and ground floor WC. The first floor has three bedrooms, all with fitted storage, and a bathroom. Most of the windows have been replaced with uPVC double glazed units and, whilst there is gas to the building, there is no central heating system. Outside, there is a walled, mature and well stocked garden. Situated on the eastern edge of the 'Castle Quarter' there is a wide choice of amenities within easy reach, in addition to the park and Embankment. Castle Road has a number of independently owned cafes, coffee shops and delis. There are also restaurants and popular pubs to choose from. Bedford town centre is around a mile away and has a wider choice of shops as well as fast links into London by rail. EER: E



163 Castle Road, MK40 3RT

Tel: 01234 216612
www.hollandsmith.co.uk

These particulars are believed to be accurate but are not guaranteed to be so. They are intended only as a general guide and cannot be constructed as any form of contract, warranty or offer. No apparatus, equipment, fittings or services have been tested and so we cannot verify that they are in working order. The details are issued on the strict understanding that any negotiations in respect of the property are conducted through Hollands Smith Estate Agents and Valuers.