



114 Milton Road

, Clapham, MK41 6AS

Offers Over £620,000



Floor Plan

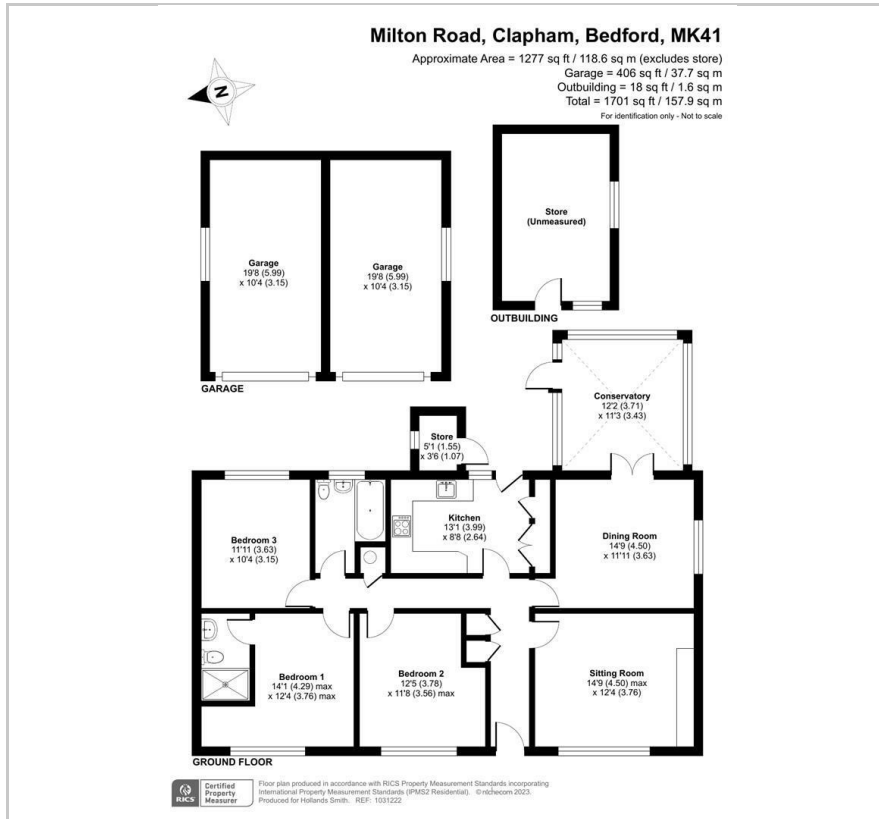

Area Map



Energy Efficiency Graph

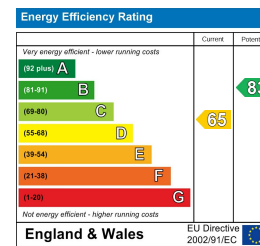

Viewing

Please contact our Bedford Office on 01234 216612 if you wish to arrange a viewing appointment for this property or require further information.

- Bungalow sitting on one third of an acre
- Two reception rooms with gas to radiator heating
- Chain Free
- Four bedrooms
- Separate family bath and ensuite shower rooms
- Large driveway providing off road parking



Available with no upward chain, this spacious detached bungalow is situated in the popular North Bedfordshire village of Clapham and occupies a plot of around half an acre. With plenty of potential to extend or develop (under permitted development rights or subject to planning consent), the bungalow sits back from the road with a large driveway providing off road parking for up to ten cars leading to a detached double garage. The main bedroom has the benefit of an en suite shower room, there are two further double bedrooms, a contemporary family bathroom and a modern fully fitted kitchen with plenty of storage and some built-in appliances. There is a separate sitting room (or fourth double bedroom) and dining room as well as a conservatory to the rear. The gardens are a particular feature and include a wide frontage and extensive lawned areas. The sweeping driveway leads to the parking area at the front and rear of the property, in addition to the detached double garage which has power connected. The garden is mainly laid to lawn with mature trees. Clapham has a good choice of amenities including shops, a post office, public houses, a village church and a lower school. It is around three miles from Bedford town centre and the Harpur Trust schools and has transport links to both the M1 and the A1. Further local attractions include popular schools for all ages, Beds and County Golf Club and The Towers Health and Racquets Club. EER: D



163 Castle Road, MK40 3RT

Tel: 01234 216612

www.hollandsmith.co.uk