



99 Bower Street

, Bedford, MK40 3RB

£420,000



Floor Plan

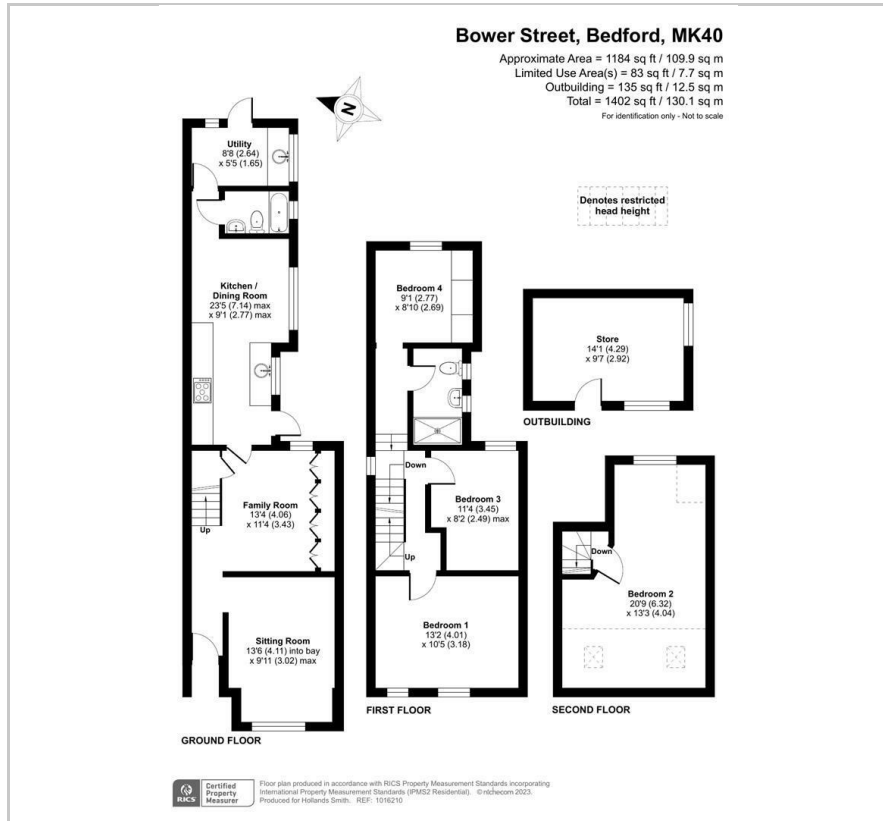

Area Map

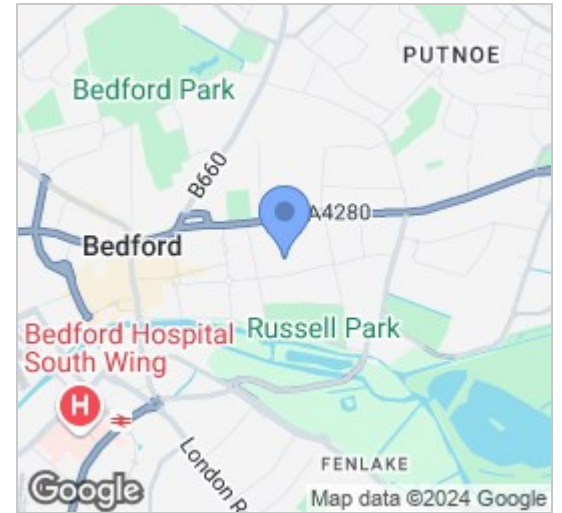

Energy Efficiency Graph

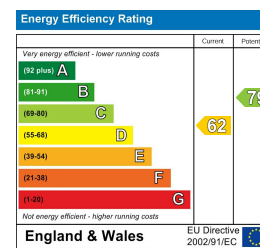

Viewing

Please contact our Bedford Office on 01234 216612 if you wish to arrange a viewing appointment for this property or require further information.



This period end of terrace home has been the subject of considerable extension and now provides spacious and adaptable accommodation arranged over three floors. The ground floor provides a self-contained sitting room to the front, a second reception room with built in shelving and storage and a kitchen/dining room with plenty of space space for a table as well as a range of fitted cupboards and workspace and some integrated appliances. In addition there is a ground floor bathroom and utility room to the rear. The first floor has three double bedrooms as well as a shower room with a contemporary white suite including a large shower cubicle rain shower. The converted loft provides a further double bedroom. All bar one of the windows have been replaced with uPVC double glazed units, there is gas to radiator heating from a combination boiler and, outside, there is a part walled garden with the added benefit of a brick-built outbuilding.

Situated in the heart of the Castle Road area, there is a good range of amenities on the doorstep including coffee shops, cafes and restaurants. The area is also home to the outstanding-rated castle Newnham Primary School as well as Russell Park at the end of the road. Bedford town centre is a short walk away and has a wide choices of shops, bars and restaurants as well as fast rail links into London St Pancras. EER: D



163 Castle Road, MK40 3RT

Tel: 01234 216612

www.hollandsmith.co.uk