



**131 Howbury Street**

, Bedford, MK40 3QT

**£450,000**



## Floor Plan

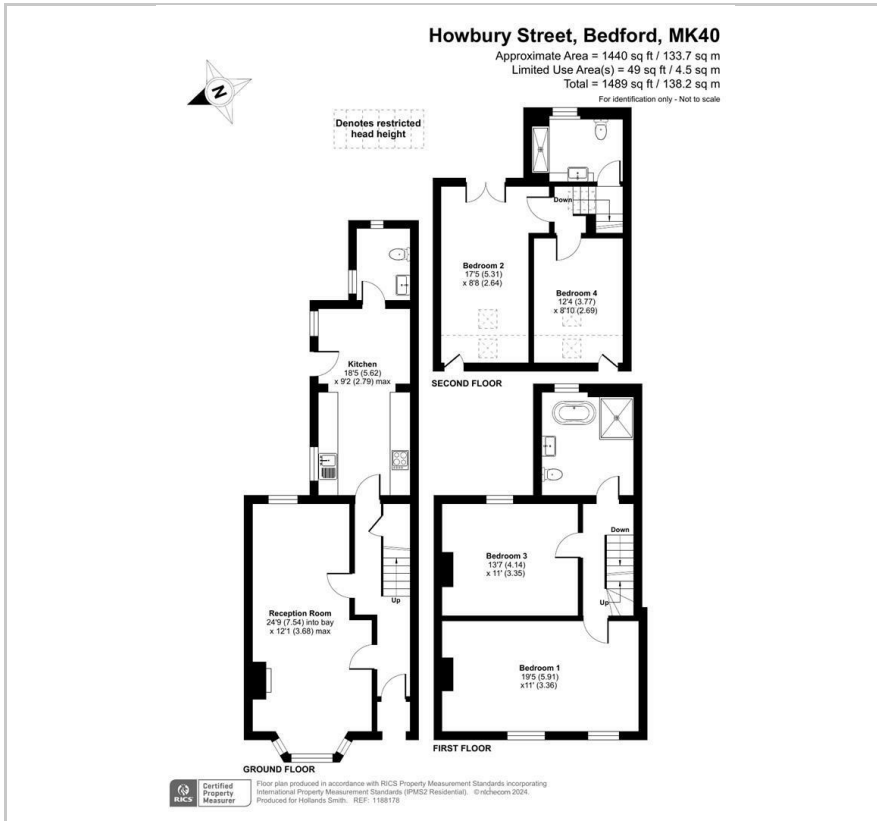

## Area Map

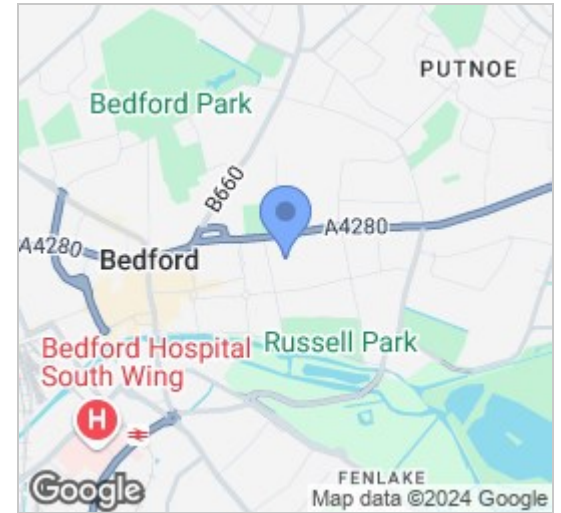

## Energy Efficiency Graph

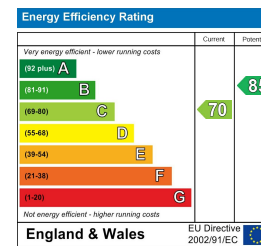

## Viewing

Please contact our Bedford Office on 01234 216612 if you wish to arrange a viewing appointment for this property or require further information.



This attractive period terrace has been the subject of recent improvement and enlargement and is now available with no upward chain. Offering spacious and adaptable accommodation arranged over three floors, there are four bedrooms and the useful benefit of a WC or bathroom on each floor. The spacious through-living room has a bay window a feature fireplace and the kitchen/breakfast room has been recently refitted to include some integrated appliances. Both bathrooms are fitted in a period style with details such as a free-standing bath and walk-in showers and further features of the period include fireplaces in the first floor bedrooms, stripped wood floors and some new double glazed wooden sash windows. The first and second floor accommodation extends full way across the side passageway, providing additional bedroom space. To the rear, there is a well-kept walled rear garden laid mainly to lawn. Howbury Street is located in the heart of the 'Castle Quarter' of the town, with a choice of coffee shops, cafes and delis all on the doorstep. Russell Park is at the end of the road with the Embankment just beyond and the area is also home to the outstanding-rated Castle Newnham Primary School. Bedford town centre is a short walk away and offers a number of shops, bars and restaurants as well as fast links into London St Pancras by rail. EER: C



**163 Castle Road, MK40 3RT**

**Tel: 01234 216612**

**[www.hollandsmith.co.uk](http://www.hollandsmith.co.uk)**