



137 Goldington Road

, Bedford, MK40 3EL

£450,000



Floor Plan

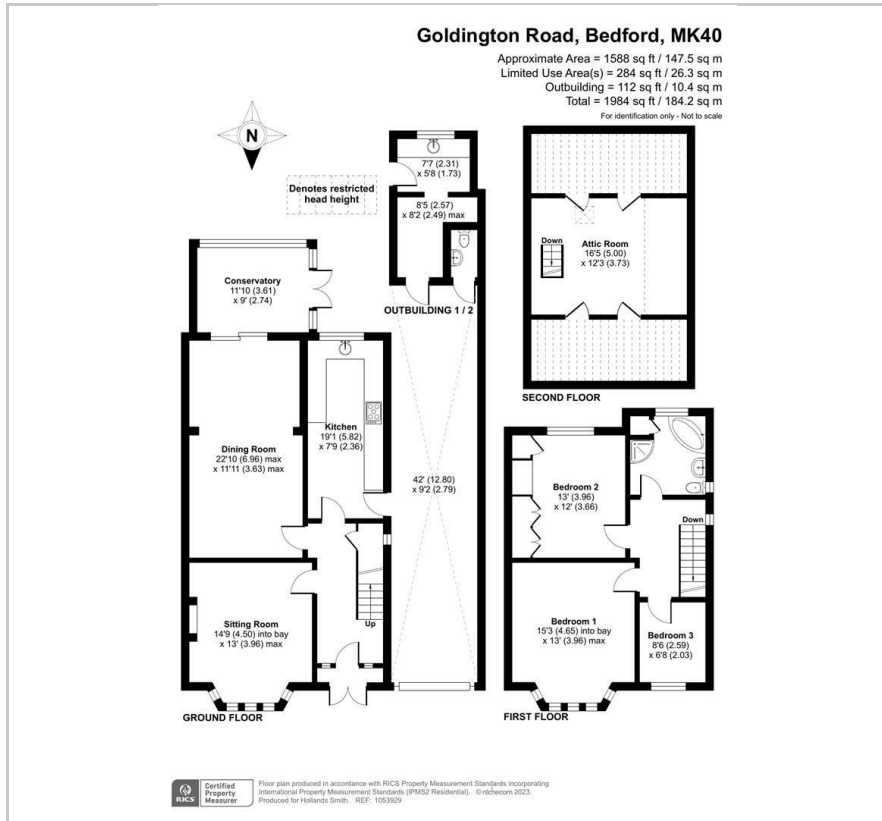

Area Map



Energy Efficiency Graph

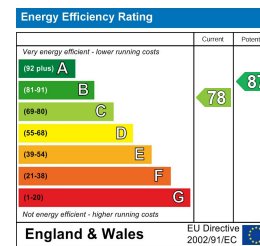

Viewing

Please contact our Bedford Office on 01234 216612 if you wish to arrange a viewing appointment for this property or require further information.



Occupying a generous, south facing garden plot this established bay fronted semi detached home lies on the edge of the popular 'Castle Quarter'. The spacious accommodation has been extended on the ground floor to provide an enlarged kitchen and dining room whilst a conservatory has been added which overlooks the garden. The wide entrance hall and landing areas feed the separate reception rooms downstairs, three bedrooms and the four piece bathroom upstairs. Outside, there is an adjoining double length carport and outbuildings which provide an exterior utility room and garden WC. The deep, south facing garden is landscaped and well screened and features sunny, private sitting areas. The house is conveniently located for the independent coffee shops and delis on the thriving Castle Road and is within a short walk of the 'outstanding' Ofsted rated Castle Newnham Primary School. EPC rating: C

This traditional 1930's semi detached home has been extended and updated in recent years to provide spacious and versatile accommodation. The loft is boarded and has a Velux window which brings natural light into the space. The conservatory has been roofed for 'all year round' use. Additional insulation has been added to the north facing front elevation and there are solar panels to reduce heating costs. There is off road parking to the front. The property lies within a mile to the east of the town centre in a popular residential area which is well served by local shops and schools.



163 Castle Road, MK40 3RT

Tel: 01234 216612

www.hollandsmith.co.uk