



West Court Goldington Green

, Bedford, MK41 0AJ

£195,000



Floor Plan

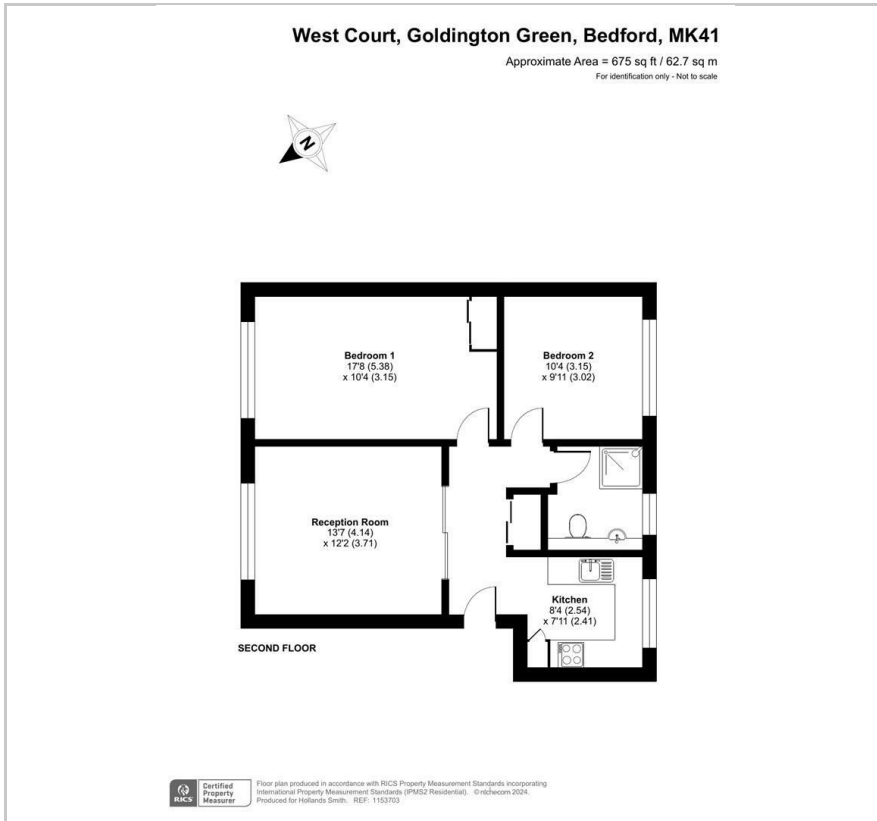

Area Map



Energy Efficiency Graph

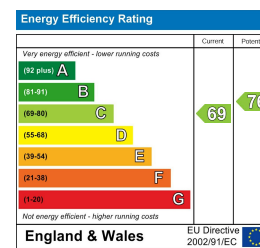

Viewing

Please contact our Bedford Office on 01234 216612 if you wish to arrange a viewing appointment for this property or require further information.



This spacious second floor flat is quietly situated on a popular purpose built development and enjoys an open, leafy aspect over Goldington Green. The particularly airy accommodation features large windows which bring much natural light in to the living space - the main bedroom has a double, predominantly south facing aspect over the adjoining green. There are two double bedrooms, a contemporary kitchen and shower room and a living room. All of the windows are uPVC double glazed (replaced within the last two years) and there are electric convactor heaters. Outside, the communal lawns are well maintained and there is a secure, single garage with parking to the front. We understand that the property is held on a 999 year lease of which approximately 60 years have expired. Located close to a large green, a number of pubs and restaurants are within easy reach together with Priory Country Park. A small retail park including Tesco and Waitrose stores is also close at hand. EPC Rating: C Council Tax Band: B Payable for 23/24 £1,728.99

The particularly light and spacious feel is a feature of the apartment throughout. There is a security entryphone system to the building and - occupying the top floor - the property enjoys the benefit of loft storage. Held on a long lease we understand that the current annual service/maintenance charge for the calendar year is £882; this includes internal cleaning of all communal areas and weekly garden maintenance.



163 Castle Road, MK40 3RT

Tel: 01234 216612

www.hollandsmith.co.uk