



95 Bower Street

, Bedford, MK40 3RB

£300,000



D



## Floor Plan

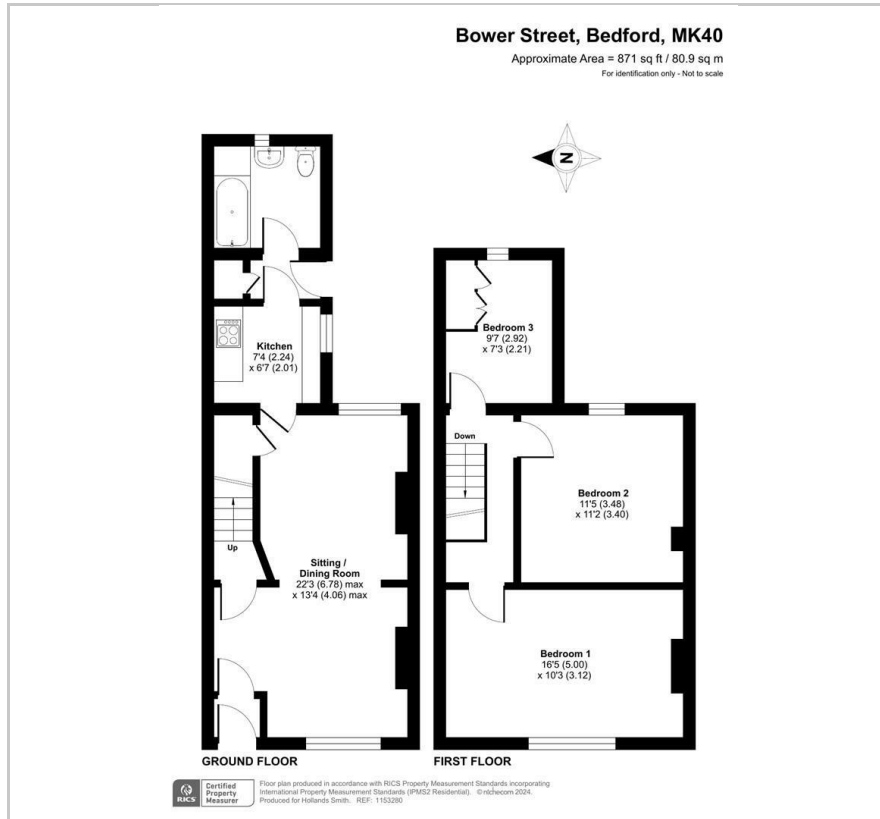

## Area Map



## Energy Efficiency Graph

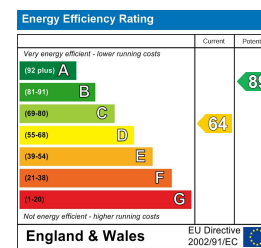

## Viewing

Please contact our Bedford Office on 01234 216612 if you wish to arrange a viewing appointment for this property or require further information.



This period terraced cottage is situated in the heart of the Castle Road area and is available with no upward chain. The accommodation, which would benefit from general improvement throughout, includes an open plan living room, kitchen and ground floor bathroom with shower over. The first floor extends fully across the side passageway and provides three bedrooms including two spacious doubles. All of the windows are double glazed and there is gas to radiator heating from a modern boiler. Outside, there is an enclosed courtyard style garden with mature trees and shrubs and a wood-cabin style shed to remain.

The immediate Castle Road area provides a wide choice of amenities including a range of independently-owned shops, cafes and restaurants. Russell Park as at the end of the street with The Embankment beyond and the area is also home to the outstanding-rated castle Newnham Primary School. Bedford's town centre is only a short walk away and offers a wider range of shops as well as fast links into London by rail. EER: D



**163 Castle Road, MK40 3RT**

**Tel: 01234 216612**

**[www.hollandsmith.co.uk](http://www.hollandsmith.co.uk)**