



24 Palmerston Street

, Bedford, MK41 7SE

£310,000



Floor Plan

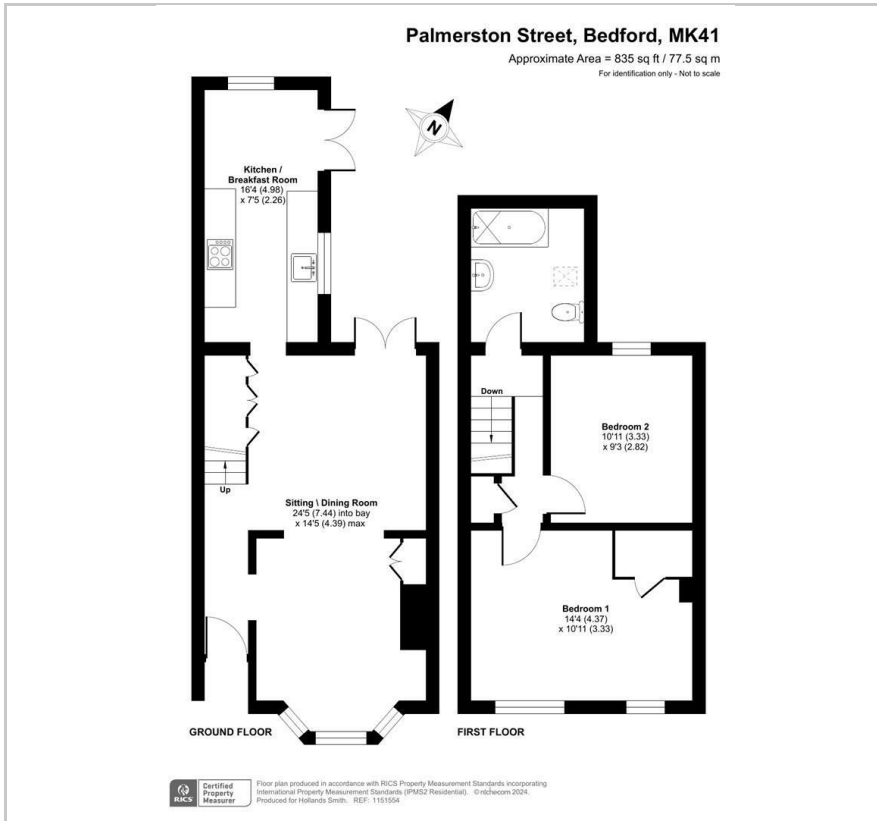

Area Map



Energy Efficiency Graph

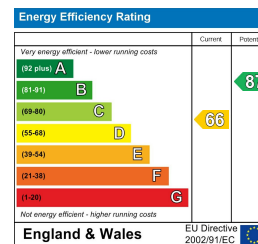

Viewing

Please contact our Bedford Office on 01234 216612 if you wish to arrange a viewing appointment for this property or require further information.

- Terraced
- Energy Rating : D
- 2 Beds
- Gas Central Heating



Available with no upward chain, this period terraced home is situated within the popular 'Prime Ministers' area of the town, close to a good range of amenities as well as Bedford town centre. Offering spacious accommodation, the living/dining room have been combined to provide one open plan room with bay window with wooden shutters fitted, an open fireplace and French doors to the rear garden. The kitchen/breakfast room has plenty of storage and also has French doors to the garden. There are two double bedrooms with the main bedroom having a large built-in wardrobe. There is also a first floor bathroom with a white suite and a Velux window for additional light. There is gas to radiator heating and all of the windows are double glazed. Outside, there is a sunny, west facing garden.

The 'Prime Ministers' area of Bedford is conveniently located for the town centre with its wide range of shops, bars and restaurants. The mainline rail station is within walking distance and has fast links to London St Pancras. Closer to hand, Bedford Park is just around the corner, as are a number of amenities including convenience stores, pubs and a bakery. EER: D



163 Castle Road, MK40 3RT

Tel: 01234 216612

www.hollandsmith.co.uk