



9 Beresford Road

, Bedford, MK40 3SD

£450,000



Floor Plan

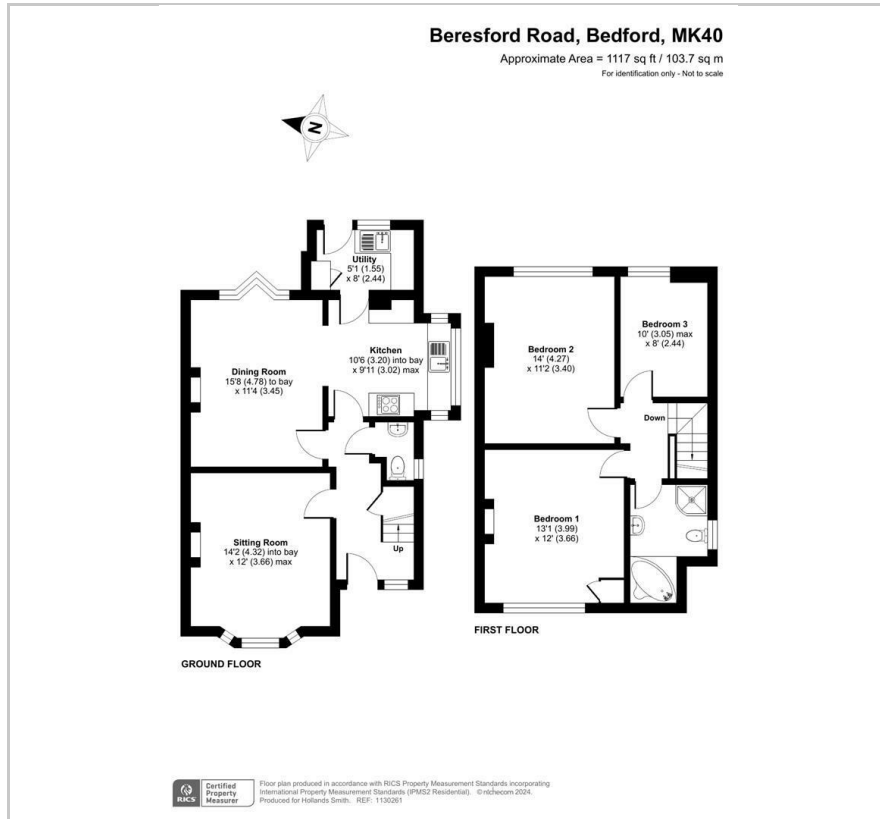

Area Map



Energy Efficiency Graph

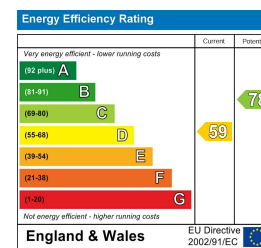

Viewing

Please contact our Bedford Office on 01234 216612 if you wish to arrange a viewing appointment for this property or require further information.

This traditional semi detached home occupies a quiet position within the Castle Road area and offers well-presented and spacious accommodation throughout. The ground floor offers a self-contained front sitting room and a separate dining room which is semi open-plan with the kitchen which has a good range of units, wooden worktops and a feature square bay window to the side. There is also the useful addition of a utility room to the rear as well as a spacious entrance hall and a ground floor cloakroom. There are three bedrooms on the first floor along with a bathroom which has been refitted and includes a corner bath and large separate shower cubicle. Further benefits include period fireplaces to most rooms, stripped wood floors and doors and there is plenty of natural light with large double glazed windows. There is also gas to radiator heating from a modern combination boiler. Outside, there is a well-kept walled garden with both lawn and patios areas and private gated side access. Beresford Road is a quiet 'no through road' and lies on the Eastern edge of the 'Castle Quarter' just a few minutes' walk from The Embankment, Russell Park and the range of cafes and independently owned shops the area offers. Further amenities in the area include the outstanding-rated Castle Newnham Primary School and a small cinema/restaurant complex. Priory Country Park is also close by and Bedford town centre is under a mile away with fast links to London available by rail. EER: D



163 Castle Road, MK40 3RT

Tel: 01234 216612

www.hollandsmith.co.uk