



42 Hindburn Close

, Bedford, MK41 7YJ

£245,000

Floor Plan

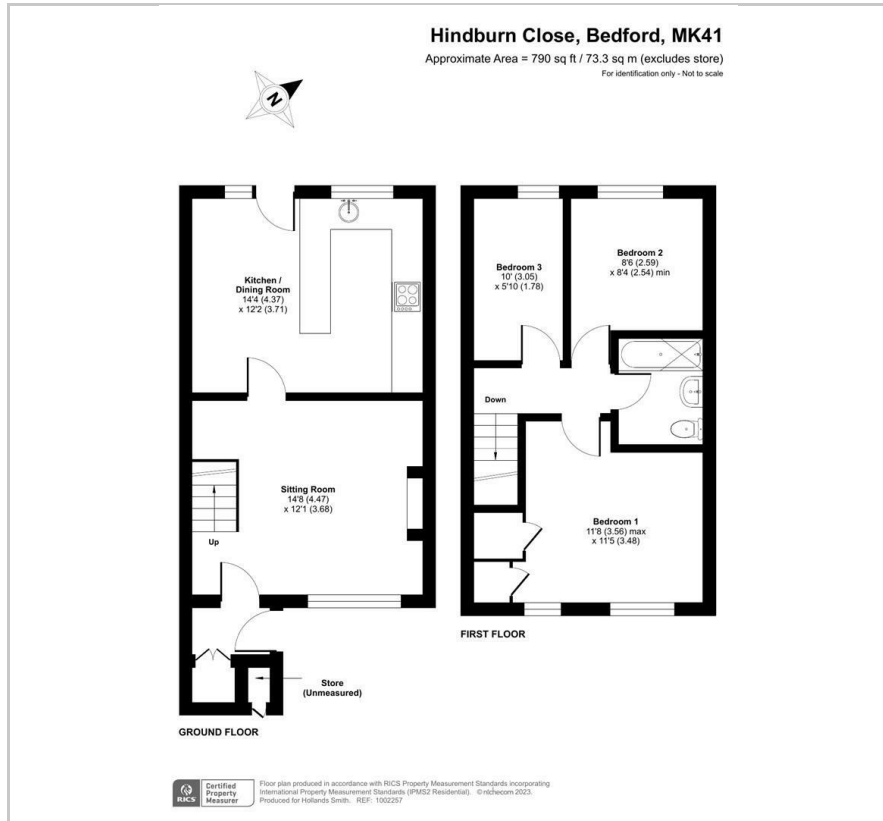

Area Map

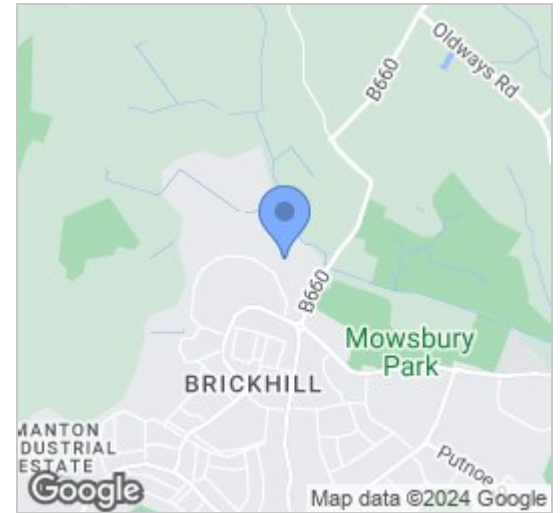

Energy Efficiency Graph

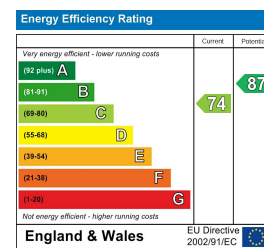

Viewing

Please contact our Bedford Office on 01234 216612 if you wish to arrange a viewing appointment for this property or require further information.



Quietly situated overlooking a small green, this modern terraced home is available with no onward chain. The accommodation features three bedrooms, a living room, bathroom and kitchen/dining room. There is a garage in a block beyond the green. Outside, the enclosed rear garden enjoys a predominantly west facing aspect. There is gas radiator heating and all of the windows are uPVC double glazed although some cosmetic improvement is required. Lying on the northern edge of the town, the property is in a popular residential area well served by local shops and schools for all ages. EER: C

Situated just off Tyne Crescent, country walks and Mowsbury Park are close at hand. The property will benefit from cosmetic improvement and represents an ideal opportunity for the first time buyer or investor. Situated some two miles to the north of the town centre, Bedford provides a range of retail and leisure facilities together with a fast rail route into London's St Pancras (approx. 40 mins).



163 Castle Road, MK40 3RT

Tel: 01234 216612

www.hollandsmith.co.uk