



**17A, KILCREGGAN
VIEW, GREENOCK, PA15 3JA**



 **neillclerk**
ESTATE AGENTS





Description

CLOSING DATE 16TH JULY AT 11AM

Offering an ideal rental investment opportunity this two bedroom GROUND FLOOR FLAT lies convenient for amenities, local schooling and transport facilities. A degree of redecoration is required which is reflected in the asking price. There is a security door entry system. Specification includes: double glazing and wet electric central heating (not tested). There is a a shared rear drying green.

Accommodation comprises: Entrance Hallway with two inbuilt cupboards. There is a front facing Lounge. The Kitchen features a rear window, high gloss grey fitted units, grey toned work surface areas and wet wall panelling.

There are two double sized Bedrooms. The Bathroom with rear window has a three piece suite including: pedestal wash hand basin, wc and bath.

Early inspection is advised for this affordable property. EPC = E.

Offers Over £35,000



Measurements

Hall

Lounge

4.83m x 3.56m (15'10 x 11'8)

Kitchen

3.15m x 1.93m (10'4 x 6'4)

Bedroom 1

2.77m x 3.12m (9'1 x 10'3)

Bedroom 2

3.71m x 2.97m (12'2 x 9'9)

Bathroom

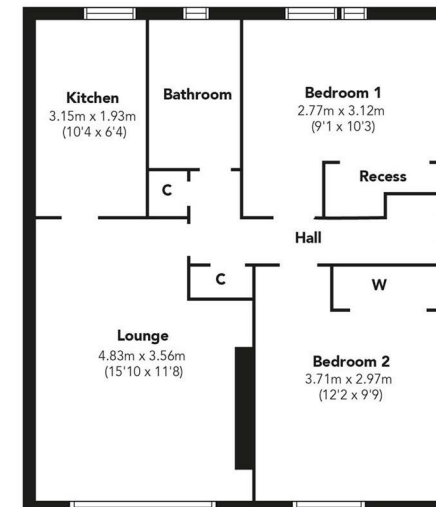

Floorplans are indicative only - not to scale
Produced by Plushplans



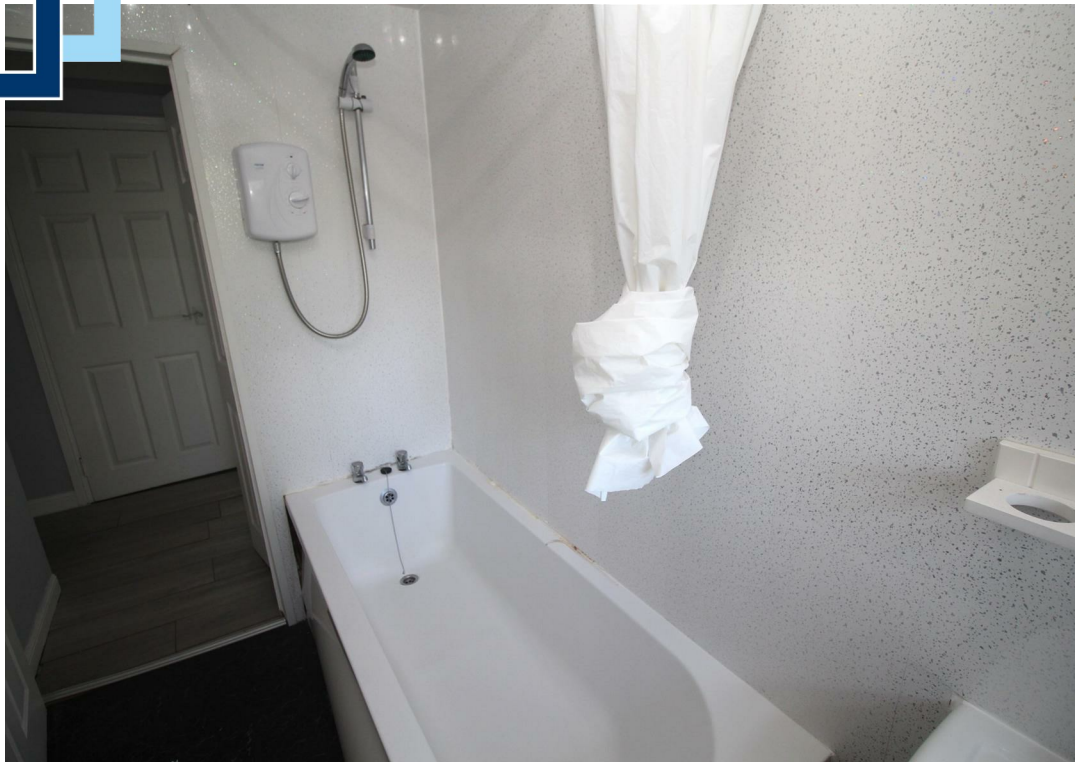





The
next
step..



To view call 01475 888400. Speak to us 7 days a week until 11pm every day to book your viewing appointment.

House to sell or rent?

Call 01475 888400 to book your free market appraisal.

Require a solicitor?

Ask us to supply a free legal quotation from Neill Clerk & Murray, Solicitors.

www.neillclerkmurray.co.uk

Stay fully up-to-date by following Neill Clerk on:



**60 West Blackhall Street
Greenock
Renfrewshire
PA15 1UY**

t: 01475 888400

e: sales@neillclerk.co.uk

w: www.neillclerk.co.uk



Agents Notes:

These sales particulars are set out as a general outline only, issued in good faith, but do not constitute representations of fact and do not form part of any offer or contract. Any services, equipment, appliances, fittings or central heating systems have not been tested and no warranty is given or implied that these are in working order. All measurements are approximate and for guidance only.

Neither Neill Clerk Estate Agents nor any of its employees or agents has any authority to make or give any representation or warranty whatever in relation to this property.

Find all our properties at: [**rightmove**](#)  [**Zoopla**](#)  [**nTheMarket.com**](#) [**s1homes.com**](#)