



BROUGHAM
STREET

**1,2 33, BROUGHAM
STREET, GREENOCK, PA16 8AG**



 **neillclerk**
ESTATE AGENTS



Description

This immaculately presented, freshly decorated two bedroom FIRST FLOOR FLAT offers contemporary stylish living within a traditional red sandstone property. Occupies a desirable West End location a short distance from the waterfront at the Esplanade. Offers an ideal first time purchase or rental investment opportunity. Specification includes; double glazing and gas central heating. The building is protected by a security door entry system. There is an attractive entrance stair with period style ornate handrails, stained glass windows and feature wall tiling. Spacious south facing shared drying green is located to the rear of the property.

Apartments comprise: welcoming Reception Hallway by timber door with single glazed panel above, generous sized walk in storage cupboard and further inbuilt cupboard. The rear facing Lounge overlooks the shared rear drying green and is an airy south facing apartment which is on open plan with the Kitchen. The stylish Kitchen features quality white high gloss units, marble style work surfaces and splashback tiling. Appliances include: stainless steel chimney extractor hood, electric ceramic hob and oven. A separate Utility Room has two rear facing windows, matching white fitted units and sink unit, plus offers space for integrated washing machine, separate under counter fridge and freezer.

The front facing bay windowed Bedroom is a spacious apartment with glazed shelved alcove, ornate ceiling rose and cornice. There is a 2nd double sized front facing Bedroom also benefits from an ornate ceiling rose. The Bathroom features a three piece suite offering: pedestal wash hand basin, wc and bath with chrome style shower plus chrome heated towel rail.

Viewing is highly recommended for this beautifully presented home. EPC = C

Measurements

Reception Hallway

Lounge
4.32 x 3.81 (14'2" x 12'6")

Kitchen
1.32 x 2.82 (4'4" x 9'3")

Utility
2.18 x 2.24 (7'2" x 7'4")

Bedroom 1
3.99 x 5.59 (13'1" x 18'4")

Bedroom 2
3.30 x 4.80 (10'10" x 15'9")

Bathroom

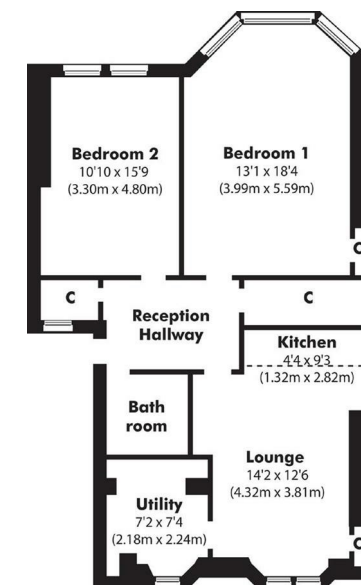

Floor plans are indicative only - not to scale.











The
next
step..



To view call 01475 888400. Speak to us 7 days a week until 11pm every day to book your viewing appointment.

House to sell or rent?

Call 01475 888400 to book your free market appraisal.

Require a solicitor?

Ask us to supply a free legal quotation from Neill Clerk & Murray, Solicitors.
www.neillclerkmurray.co.uk

Stay fully up-to-date by following Neill Clerk on:



**60 West Blackhall Street
Greenock
Renfrewshire
PA15 1UY**

t: 01475 888400

e: sales@neillclerk.co.uk

w: www.neillclerk.co.uk



Agents Notes:

These sales particulars are set out as a general outline only, issued in good faith, but do not constitute representations of fact and do not form part of any offer or contract. Any services, equipment, appliances, fittings or central heating systems have not been tested and no warranty is given or implied that these are in working order. All measurements are approximate and for guidance only.

Neither Neill Clerk Estate Agents nor any of its employees or agents has any authority to make or give any representation or warranty whatever in relation to this property.

Find all our properties at: [rightmove](https://www.rightmove.co.uk) [Zoopla](https://www.zoopla.co.uk) [onTheMarket.com](https://www.onthemarket.com) [s1homes.com](https://www.s1homes.com)