

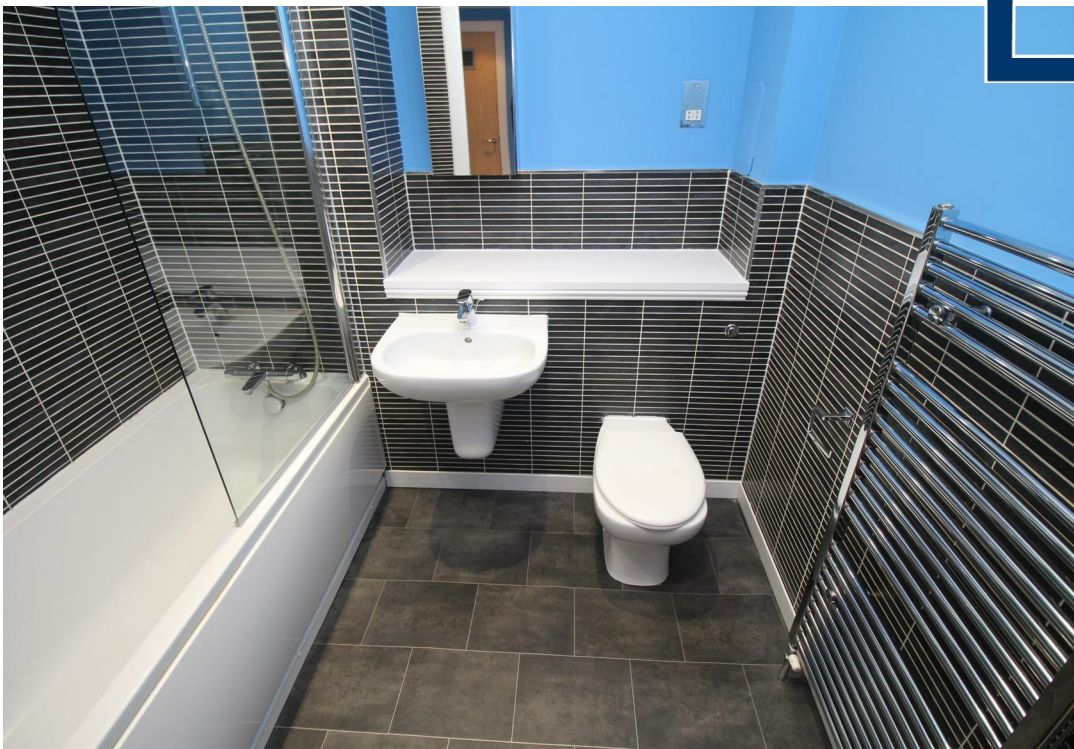

**G/1, 100, HARBOURSIDE, INVERKIP, PA16  
0BA**





## Description

This immaculately presented, pristine one bedroom GROUND FLOOR FLAT occupies a rarely available setting close to the waterfront within the sought after Harbourside development. In 2022 the interior was extensively upgraded with installation of a new fitted kitchen, new laminate flooring, new window shutters and an alarm system installed. In addition, the interior has just been freshly redecorated.

There is a access to a communal rear garden which features views over the Firth of Clyde towards Cowal and Isle of Arran. The garden benefits from lawned / paved areas. Lies next to the Kip Marina which is recognised as one of Scotland's finest marinas. Inverkip has a railway station with regular service to Glasgow.

There is an allocated parking space. Specification includes: double glazing and gas central heating. Security door entry system. The beautiful fresh interior is highly impressive. A reception area shared with the neighbouring flat leads to the apartment.

Superb accommodation comprises: Hallway by timber door with walk in inbuilt cupboard. The generous sized Lounge is reached by door with porthole panels and features two front facing windows offering views towards the marina. There is a quality refitted Kitchen which is on semi open plan with the lounge. The kitchen benefits from white fitted units and marble effect work surfaces. Appliances include: chimney extractor hood, stainless steel gas hob, electric oven, full height freezer, integrated full height fridge, dishwasher and washing machine.

The front facing Bedroom is a bright room with fitted wardrobe. The quality Bathroom features a semi pedestal wash hand basin, wc and bath with mixer shower. Additional benefits include: partial wall tiling and chrome style heated towel rail.

This beautiful home near the waterfront must be viewed. EPC = C.

## Measurements

Hallway

Lounge

4.22m x 5.23m (13'10 x 17'2)

Kitchen

3.48m x 2.36m (11'5 x 7'9)

Bedroom

4.29m x 3.56m (14'1 x 11'8)

Bathroom

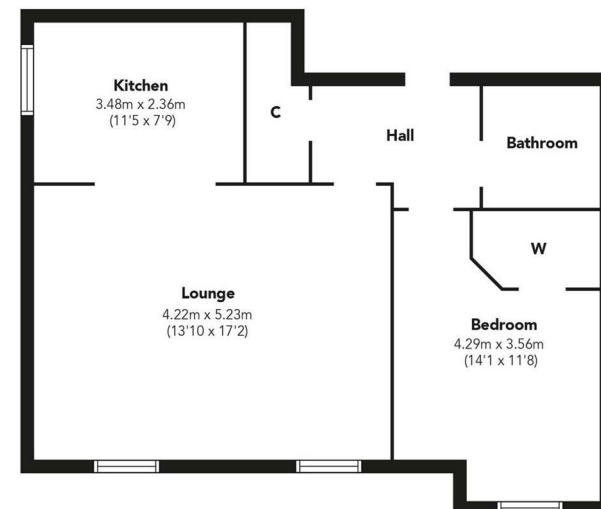

Floorplans are indicative only - not to scale  
Produced by Plushplans 











The next step..



To view call 01475 888400. Speak to us 7 days a week until 11pm every day to book your viewing appointment.

**House to sell or rent?**

Call 01475 888400 to book your free market appraisal.

**Require a solicitor?**

Ask us to supply a free legal quotation from Neill Clerk & Murray, Solicitors.

[www.neillclerkmurray.co.uk](http://www.neillclerkmurray.co.uk)

Stay fully up-to-date by following Neill Clerk on:



**60 West Blackhall Street  
Greenock  
Renfrewshire  
PA15 1UY**

**t: 01475 888400**

**e: [sales@neillclerk.co.uk](mailto:sales@neillclerk.co.uk)**

**w: [www.neillclerk.co.uk](http://www.neillclerk.co.uk)**



**Agents Notes:**

These sales particulars are set out as a general outline only, issued in good faith, but do not constitute representations of fact and do not form part of any offer or contract. Any services, equipment, appliances, fittings or central heating systems have not been tested and no warranty is given or implied that these are in working order. All measurements are approximate and for guidance only.

Neither Neill Clerk Estate Agents nor any of its employees or agents has any authority to make or give any representation or warranty whatever in relation to this property.