



11, LANGHOUSE MEWS, INVERKIP, PA16
0GG





Description

FROM 13TH JANUARY 2024 = OPEN VIEWING EVERY SATURDAY 10AM - 3PM - NO NEED TO BOOK IN ADVANCE Other viewing times by appointment. Imagine stepping onto your balcony from the lounge or dining room and seeing this view! This exciting development of two newly built four bedroom luxury DETACHED VILLAS occupies an exclusive semi rural courtyard location next to historic Langhouse Mansion built in 1705. Being built to an exacting standard with quality finishes by established local builder Grenville Ltd.

Open, attractive rear views over countryside to Cowal Peninsula. The village of Inverkip offers a range of amenities including Inverkip Primary School, local shops and the famous Marina perfect for yachting enthusiasts. The railway station offers a regular service to Glasgow which is ideal for commuters. Nearby ferry terminals in Gourock and Wemyss Bay provide access to Argyll and the Isle of Bute.

Specification includes: double glazing and gas central heating. Solar heating. Hardwired for internet. NHBC guarantee. Oak internal doors. Monoblock driveway with space for two cars and garage. Lawned rear garden plus garden store. No 11 is finished with fitted carpets, Amtico flooring & floor tiling.

Impressive accommodation set over 3 levels provides spacious family living comprising:

Entrance Level: Vestibule, Hall, Plumbed Cloakroom, Utility Store, Lounge and Dining Room both with access to the balcony. Quality fitted Breakfasting Kitchen with island unit is on open plan with dining room. Appliances include: induction hob, two ovens, dishwasher & American style fridge/freezer. Lower Ground Floor: Family Room/5th Bedroom with French doors to garden, two double Bedrooms including Master Bedroom with Ensuite Shower Room/Dressing Room, Bathroom with four piece suite. First Floor Level: two double Bedrooms and Shower Room.

Secure your home with reservation fee £1000 (non-returnable). A further £2500 deposit is required when missives are concluded.

Measurements

Vestibule, Hall, WC

Lounge
3.63 x 5.45 (11'10" x 17'10")

Dining Room
3.64 x 4.01 (11'11" x 13'1")

Breakfasting Kitchen
3.34 x 4.47 (10'11" x 14'7")

Lower Ground Hallway

Family Room / 5th Bedroom
3.64 x 4.45 (11'11" x 14'7")

Master Bedroom
3.64 x 5.38 (11'11" x 17'7")

Dressing Room/ Ensuite Shower Room
1.08 x 1.78 (3'6" x 5'10")

Bedroom 2
3.64 x 3.40 (11'11" x 11'1")

Bathroom

First Floor Level

Bedroom 3
3.61 x 4.32 (11'10" x 14'2")

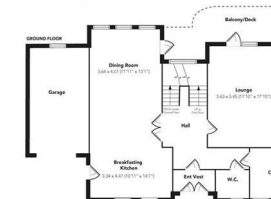

Floorplans are indicated only - not to scale.
Produced by Property IQ











The
next
step..



To view call 01475 888400. Speak to us 7 days a week until 11pm every day to book your viewing appointment.

House to sell or rent?

Call 01475 888400 to book your free market appraisal.

Require a solicitor?

Ask us to supply a free legal quotation from Neill Clerk & Murray, Solicitors.
www.neillclerkmurray.co.uk

Stay fully up-to-date by following Neill Clerk on:



**60 West Blackhall Street
Greenock
Renfrewshire
PA15 1UY**

t: 01475 888400

e: sales@neillclerk.co.uk

w: www.neillclerk.co.uk



Agents Notes:

These sales particulars are set out as a general outline only, issued in good faith, but do not constitute representations of fact and do not form part of any offer or contract. Any services, equipment, appliances, fittings or central heating systems have not been tested and no warranty is given or implied that these are in working order. All measurements are approximate and for guidance only.

Neither Neill Clerk Estate Agents nor any of its employees or agents has any authority to make or give any representation or warranty whatever in relation to this property.