



# Windermere

**£355,000**

Yewgarth, Ground Floor Flat, New Road, Windermere, Cumbria, LA23 2LA

A large spacious 2 bedroomed newly converted ground floor flat, with new kitchen and bathroom and with a garage available separately, parking and garden area all within level walking distance of the village centre.

The apartment is subject to an occupancy condition. Please ask for further details or look at the LDNPA website (7/2022/5724).

## Quick Overview

- 2 bedroomed ground floor flat
- En-suite shower room to main bedroom
- Further en-suite bathroom
- Detached garage available separately
- Off road parking
- Garden area
- Level walking distance to village
- Occupancy conditions apply

Property Reference: W6042



2



1



1



C



Superfast  
fibre  
Broadband



Off Road  
Parking

## Proposed Ground Floor

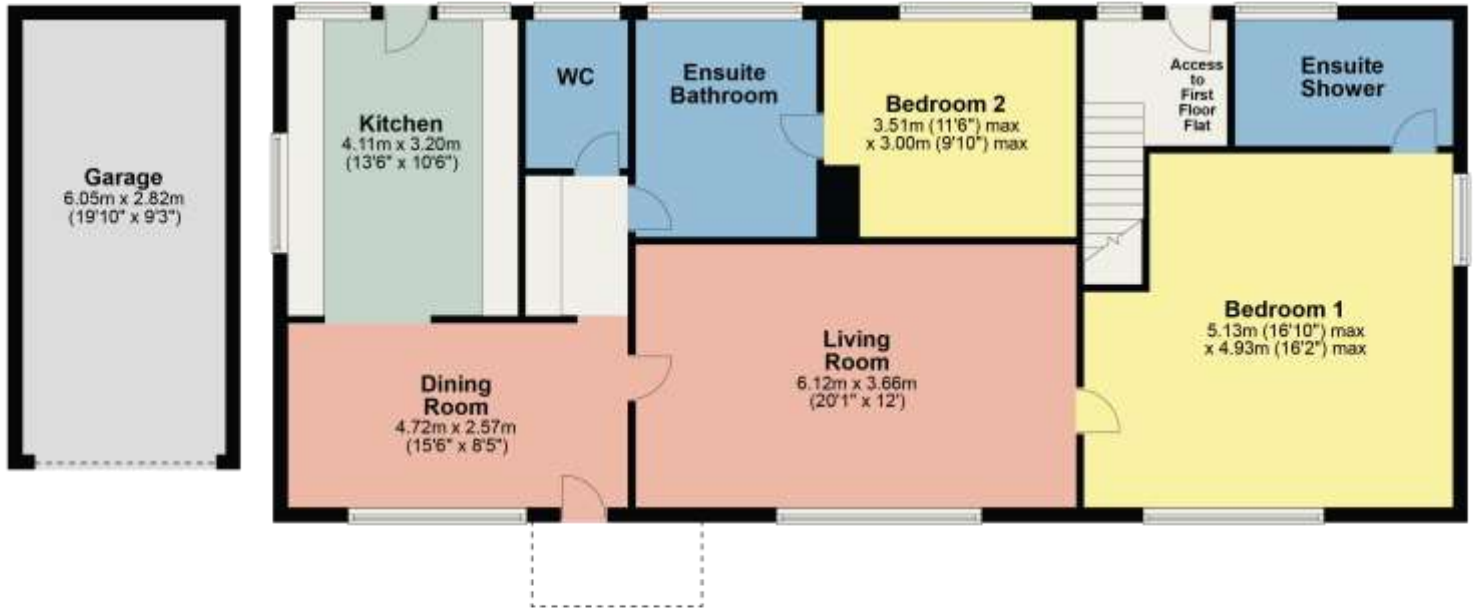

This plan is for layout guidance only and is not drawn to scale unless stated. Windows and door openings are approximate. Whilst every care is taken in preparation of this plan, please check all dimensions, shapes and compass bearings before making any decision reliant upon them. REF: W6042

**Description:** A large spacious 2 bedroomed newly converted ground floor flat, with new kitchen and bathroom and with a garage available separately, parking and garden area all within level walking distance of the village centre.

The apartment is subject to an occupancy condition. Please ask for further details or look at the LDNPA website (7/2022/5724).

**Location:** Within 200 yards of Windermere village, located on New Road, being the main Windermere to Bowness road. From central Windermere follow New Road towards Bowness and Yewgarth can be found a short way on your left hand side, just past the Howbeck.

### Accommodation: (with approximate measurements)

**Living Room** 20' 1" x 12' 0" (6.12m x 3.66m)

**Dining Room** 15' 6" x 8' 5" (4.72m x 2.57m)

**Kitchen** 13' 6" x 10' 6" (4.11m x 3.2m)

**W.C**

**Bathroom**

**Bedroom 1** 16' 10" max x 16' 2" max (5.13m x 4.93m)

**En-suite Shower Room**

**Bedroom 2** 11' 6" max x 9' 10" max (3.51m x 3m)

**En-suite Bathroom**

**Note:** There is an option to buy the detached garage (19'10" x 9'3") for £20,000.

### Property Information:

**Outside:** Front tarmacked parking area for 3 cars. Patio seating area to the front with screening to provide privacy from the road.

**Services:** Mains water, drainage and electricity. Gas fired central heating.

**Tenure:** Freehold - Building insurance and the service charge will be split 50/50 with the first floor flat.

**Council Tax:** Westmorland and Furness Council. As the property is currently being converted it will need to be assessed after completion.

**Viewings:** Strictly by appointment with Hackney & Leigh Windermere Sales Office.

**Energy Performance Certificate:** To be confirmed when conversion is completed.

**What3Words:** ///cliff.joys.plants

**Notes:** \*Checked on <https://checker.ofcom.org.uk> 1st February 2024 - not verified.

All permits to view and particulars are issued on the understanding that negotiations are conducted through the agency of Messrs. Hackney & Leigh Ltd. Properties for sale by private treaty are offered subject to contract. No responsibility can be accepted for any loss or expense incurred in viewing or in the event of a property being sold, let, or withdrawn. Please contact us to confirm availability prior to travel. These particulars have been prepared for the guidance of intending buyers. No guarantee of their accuracy is given, nor do they form part of a contract. \*Broadband speeds provided by <https://checker.ofcom.org.uk/en-gb/broadband-coverage>

Request a Viewing online or Call 015394 44461