



Kirkby Lonsdale

£625 pcm

Flat 6
Mill Brow House
Kirkby Lonsdale
Carnforth
Lancashire
LA6 2AT

A second floor, two bedroom furnished flat with modern bathroom and kitchen located in the conservation area of Kirkby Lonsdale with the benefit of a parking space.

- Two Bedroom Apartment
- Living Room, Kitchen
- Bathroom with Shower Over Bath
- Parking Space For One Vehicle
- Central Location
- Furnished
- Not Suitable for Pets
- No Smokers
- Council Tax Band - B
- Available Soon for a Minimum 12 month tenancy

Property Ref: KLR2372





Living Room

Location: From the Market Square facing The Royal Hotel, turn right along the Main Street and right again by the side of the Spar shop onto Mill Brow. Continue straight ahead, going down the hill and the driveway entrance to Mill Brow House is on the right.

Furnishings: The property is offered furnished including sofas, sideboards, side tables, dining table and chairs, kitchenware including crockery and cookware, beds and bedroom furniture plus sundry decorative items. White goods including washing machine, fridge with freezer compartment included as Landlords responsibility.

Services: Mains Electric, Gas, Water (Unmetered) and Drainage.
Internet Speed: <https://checker.ofcom.org.uk/en-gb/broadbandcoverage#pc=LA61RB&uprn=100110695355>

Viewings: Strictly by appointment with Hackney & Leigh – Kirkby Lonsdale Office.

Ongoing Tenancy Management: Upon tenancy commencement the property will be managed by the landlord directly.

Applying for a Tenancy: Tenancy Application Forms are available from any Hackney & Leigh office. Each application must be accompanied by payment of a Holding Deposit (one weeks rent) payable either by debit or credit card. This is paid to reserve the property and will be held by us for a period of 15 days unless we agree otherwise.

All adults of 18yrs and over who will be living at the property will be asked to provide evidence of nationality and identity to validate their "Right to Rent" under the Immigration Act 2014.

Referencing: All applicants will be required to provide satisfactory references eg: employer, current landlord and two character references. For the self-employed, a reference from your accountant or solicitor will be required. A credit reference

will be obtained for each applicant. Acceptance of references and the offer of a tenancy is at our discretion.

The Tenancy: The property will be let on a fixed term Assured Shorthold Tenancy for an initial period of 6 months. There is no automatic provision within the lease for early termination and the tenant is responsible for rent for the whole term.

The tenant is responsible for Council Tax for the tenancy period and for all charges for water and sewerage, gas, electricity, telephone or other utility/service providers' charges supplied to the tenant during the tenancy.

Deposit & Rent: The successful Tenant will be required to pay a deposit (equal to a maximum of 5 weeks rent depending on the property). This will be held in accordance with the Tenancy Deposit Scheme Regulations and will be re-fundable at the end of the tenancy, subject to the property being left in a satisfactory condition. Rent is payable on or by each rent day and is payable by standing order. One month's rent in advance PLUS the deposit, is required at the time of signing the agreement. Please Note: It is NOT possible to use the deposit as rent for the final month.

Pets: Pets are unable to be accepted at this property. Pets may not be acceptable for a number of reasons including allergies/medical reasons, conditions within the property lease, lack of outside space, communal grounds or close proximity to a main road. Acceptance of a pet is subject to the Landlords discretion.

Insurance: It is the Tenants' responsibility to insure their own possessions. Tenants are strongly advised to take out accidental damage cover in respect of the Landlord's property and contents.

Energy Performance Certificate: The full Energy Performance Certificate is available on our website www.hackney-leigh.co.uk and also at any of our offices.

How to rent: Prospective tenants are advised to read the government's leaflet which is available here: <https://www.gov.uk/government/publications/how-to-rent>



Kitchen



Bedroom

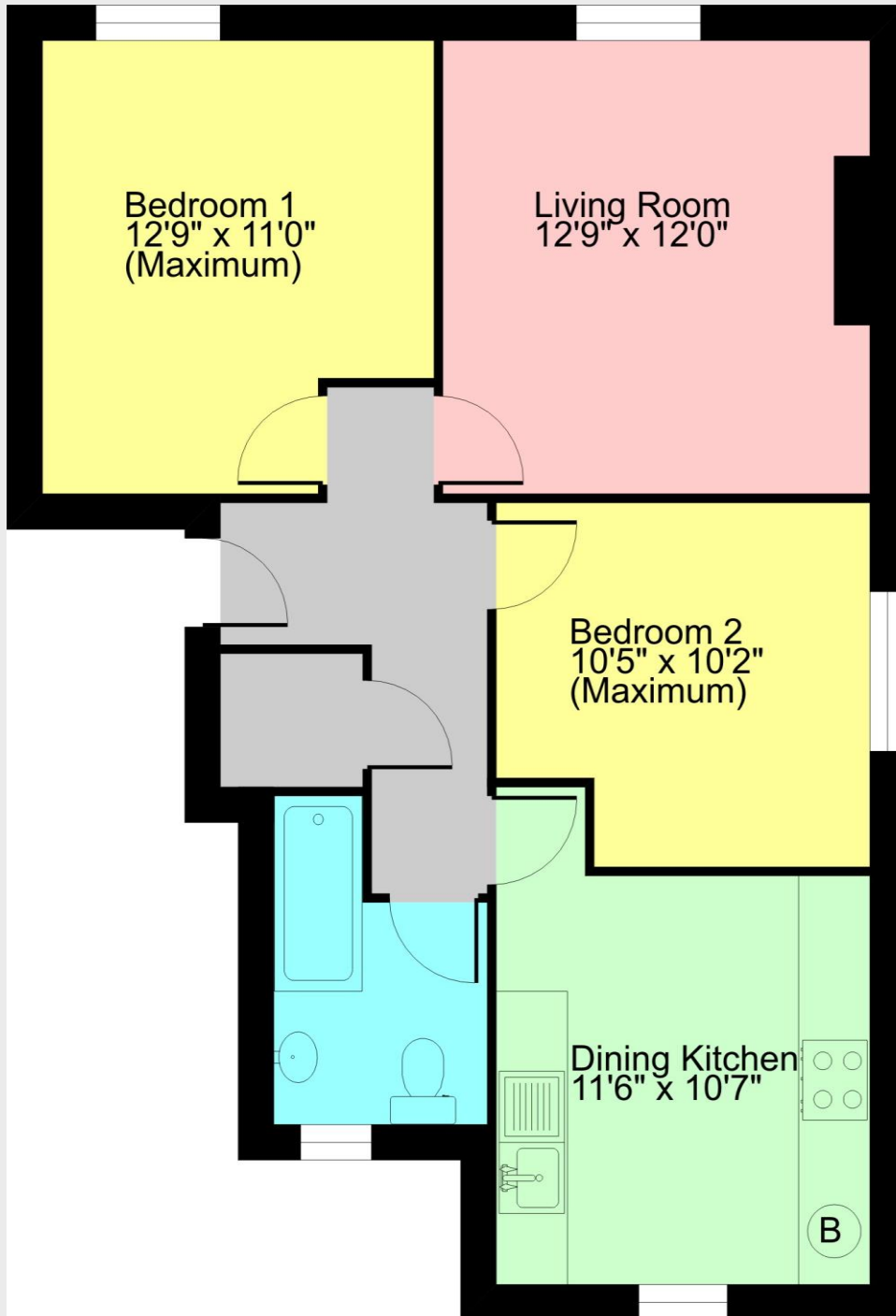

Gross internal square footage = Approx 653 Sq Ft
SKETCH PLAN FOR ILLUSTRATIVE PURPOSES ONLY

© Drawing by Business Etc Ltd. Unauthorised reproduction prohibited. Drawn in the UK.
Drawing No. KLR2372/C

Mill Brow House, Kirkby Lonsdale - Ref: KLR2372

Property particulars and appointments to view are provided on the understanding that all negotiations are conducted through Hackney and Leigh Ltd. This information is provided for general guidance only. It does not form part of any contract or agreement and no guarantee of accuracy is given. Prospective tenants should make their own enquiries as to the suitability or otherwise of the property. No responsibility can be accepted for any loss or expense incurred in viewing or in the event of a property being let or withdrawn. Please contact us to confirm the property's availability, especially if travelling some distance.