



📍 21 Bowles Court Westmead Lane, Chippenham, Wiltshire, SN15 3GU

🏠 Price Guide £125,000

A superb one bedroom first-floor apartment forming part of the highly regarded Bowles Court assisted-living development, perfectly positioned in the heart of the town and overlooking the River Avon and within a short distance of the mainline railway station (London-Paddington and Bath, Bristol-South West).

- Superb Apartment Within the Highly Regarded Bowles Court Assisted-Living Development
- Designed Exclusively for the Over-70s
- No Onward Chain
- Prime Central Location
- Flexible On-site Care and Support Available
- 24-hour emergency call system
- One Bedroom
- Presented in First-Class Order Throughout
- Underfloor Heating and Triple Glazing
- Guest Suite Available for Visitors

🏠 Leasehold

🏠 EPC Rating B



NO ONWARD CHAIN A superb one bedroom first-floor apartment forming part of the highly regarded Bowles Court assisted-living development, perfectly positioned in the heart of the town and overlooking the River Avon and within a short distance of the mainline railway station (London-Paddington).

Designed exclusively for the over-70s, this impressive development enables residents to maintain independent living in a home they own, with the advantage of flexible on-site care and support. Additional facilities include a table-service restaurant, 24-hour emergency call system, laundry room, guest suite, communal lounge, sun terrace, mobility-scooter store, and permit-controlled parking.

This particular apartment occupies a desirable first-floor position and is presented in first-class order throughout. Additional benefits include underfloor heating, triple glazing, and integrated kitchen appliances.

Situation

About 200 metres from the centre of town, Bowles Court is in the ideal spot. Conveniently located, Bowles Court is close to a variety of local supermarkets. The dynamic town centre boasts access to a local hospital and plenty of doctors surgeries. Banks, retail stores and independent shops are also in good supply. This historical market town also benefits from regular town markets. Places of interest in the local area are varied with John Coles Park, the Museum, the Heritage Centre and Chippenham Folk Festival just a few examples. For those interested in wider travel, transport links are strong with a regular bus service connecting residents to towns including Bath, Calne, Devizes, Trowbridge and Swindon. Rail links are also good and Chippenham railway station features along the main line to London Paddington. It also retains some impressive railway arches and architectural triumphs built by the famous engineer Brunel. As an ancient riverside market town, Chippenham also has plenty of historical intrigue for those interested in living in this area. Natural attractions are also found in abundance with the River Avon, the Cotswolds and Salisbury Plain you might like to visit.

Property Information

Council Tax Band; C

Leasehold

Mains Water, Electricity & Drainage

Underfloor Heating & Triple Glazing

EPC Rating; B

No Onward Chain



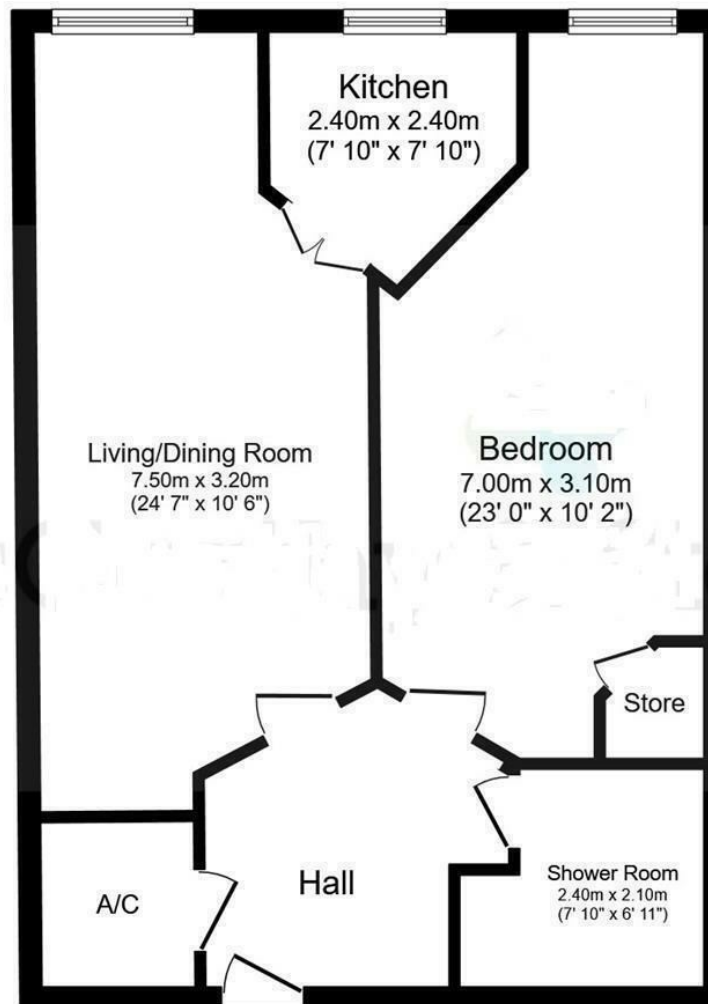

This plan is for illustration purposes only and may not be representative of the property. Plan not to scale.

Powered by focalagent.com

Disclaimer These particulars, whilst believed to be accurate are set out as a general outline only for guidance and do not constitute any part of an offer or contract. Intending purchasers should not rely on them as statements of representation of fact, but must satisfy themselves by inspection or otherwise as to their accuracy. No person in this firm's employment has the authority to make or give any representation or warranty in respect of the property. All measurements and distances are approximate only. Your home is at risk if you do not keep up repayments on a mortgage or other loan secured on it.