



📍 43 Fairfoot Close, Chippenham, Wiltshire, SN14 0PL

🏠 Price Guide £229,950

A spacious, three bedroom mid terrace house situated on the popular "Queens Crescent" residential development. The property is within walking distance of local amenities and a popular Primary School.

- Mid Terrace Property
- Three Bedrooms
- Spacious Accommodation
- Popular Residential Area
- West Chippenham
- Close to a Primary & Secondary Schools & Local Amenities
- Enclosed Rear Garden
- Great Access to Road Networks
- Easy Reach of the Town Centre & Mainline Train Station

🏡 Freehold

🏠 EPC Rating C



A spacious, three bedroom mid terrace house situated on the popular "Queens Crescent" residential development. The property is within walking distance of local amenities and a popular Primary School.

Accommodation over two floors comprises; entrance hall leading to a nice sized sitting room. The kitchen/diner is also a really good size providing access to a useful utility room that provides external access to the rear garden.

Situated to the first floor are two double bedrooms, a single bedroom and a bathroom with shower over. Bedrooms one and two benefit from having fitted storage.

To the rear is an easily maintainable garden with gated rear access. Although the property does not have allocated parking there is plenty of on street parking available nearby. The property is within walking distance of two of Chippenham's Secondary Schools and the town centre with mainline railway station are within easy reach as well as major road networks including the M4-Junction 17.

Situation

Situated on the western side of the town well placed for local amenities including shops, a pharmacy, a Doctor's surgery, primary schooling and two of the town's reputable senior schools which are close by. A more comprehensive range of amenities can be found in Chippenham town centre to include mainline railway station (London-Paddington), a public library and a sports centre. The M4 motorway at Junction 17 offers excellent motor commuting to the major centres of Bath, Bristol, Swindon and London.

Property Information

Council Tax Band; B

Freehold

Mains Gas, Electricity, Water & Drainage

Gas Central Heating

EPC Rating; TBC



Ground Floor

Approx. 515.9 sq. feet

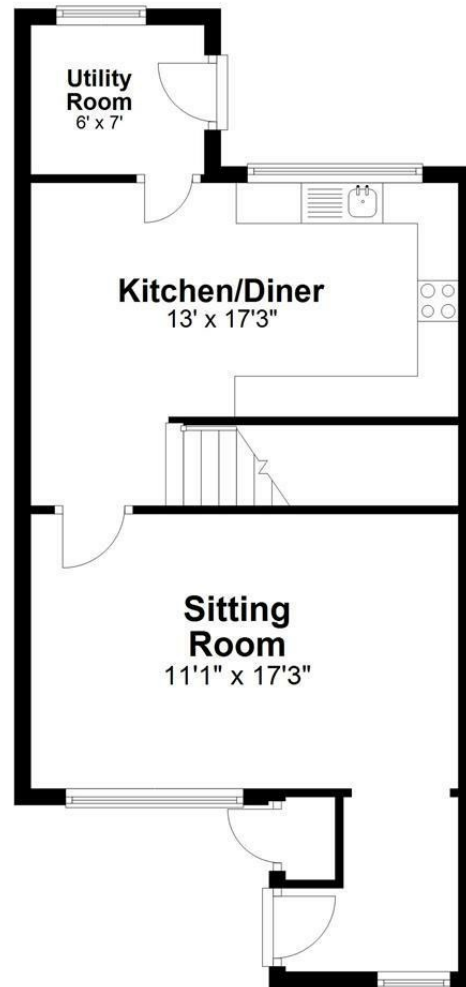

First Floor

Approx. 420.2 sq. feet

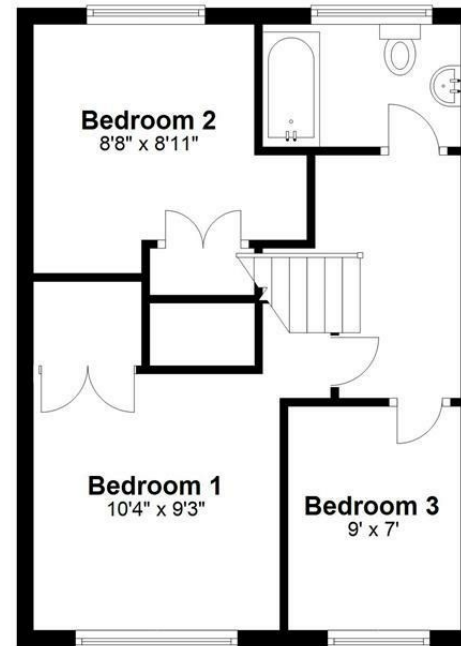

Total area: approx. 936.1 sq. feet

Disclaimer: These particulars, whilst believed to be accurate are set out as a general outline only for guidance and do not constitute any part of an offer or contract. Intending purchasers should not rely on them as statements of representation of fact, but must satisfy themselves by inspection or otherwise as to their accuracy. No person in this firm's employment has the authority to make or give any representation or warranty in respect of the property. All measurements and distances are approximate only. Your home is at risk if you do not keep up repayments on a mortgage or other loan secured on it.