

37 Siddal Lane, Halifax, West Yorkshire, HX3 9BQ

Offers Over £130,000

- : Popular & Convenient Location
- : Large garden To The Rear
- : Spacious Lounge
- : Viewing Strongly Recommended
- : End Town House
- : Modern Kitchen & Bathroom
- : Easy Access to Halifax & M62
- : Large Integral Garage & Off Road Parking
- : 2 Bedrooms
- : Realistically Priced

Approx Gross Floor Area = 582 Sq. Feet
 = 54.1 Sq. Metres

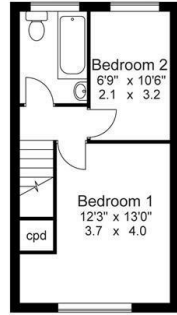

First Floor

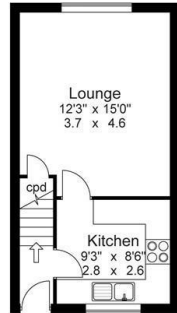

Ground Floor

For illustrative purposes only. Not to scale.

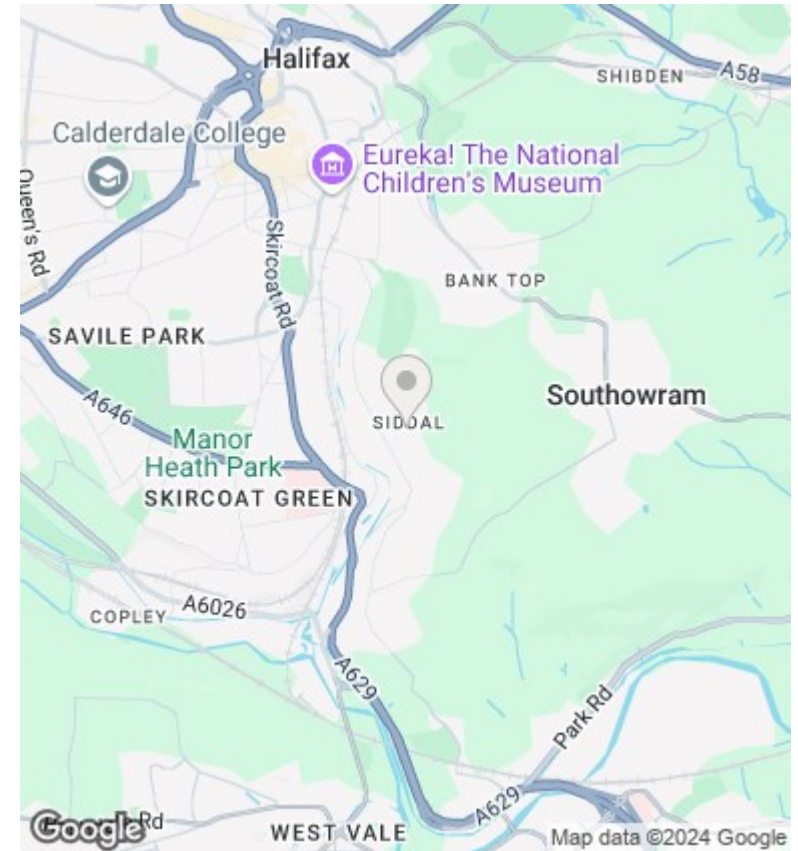

Directions

Viewings

Viewings by arrangement only. Call 01422 349222 to make an appointment.

Council Tax Band

A

EPC Rating:

Energy Efficiency Rating		Current	Potential
<i>Very energy efficient - lower running costs</i>			
(92 plus) A			
(81-91) B			
(69-80) C			
(55-68) D			
(39-54) E			
(21-38) F			
(1-20) G			
<i>Not energy efficient - higher running costs</i>			
England & Wales		EU Directive 2002/91/EC	