



23 Warley Town, Halifax, West Yorkshire, HX2 7RZ

Offers In Excess Of £180,000

- : Highly Desirable Semi Rural Location
- : 2 Double Bedrooms
- : Spacious Dining Kitchen
- : Viewing Strongly Recommended
- : Stone Built Cottage
- : Yard to the Rear
- : Easy Access to Halifax & Sowerby Bridge
- : Spacious Accommodation
- : Easy Access to Outstanding Schools
- : Realistically Priced

Approx Gross Floor Area = 783 Sq. Feet
 = 72.58 Sq. Metres



First Floor

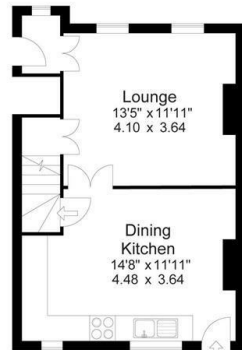

Ground Floor

For illustrative purposes only. Not to scale.

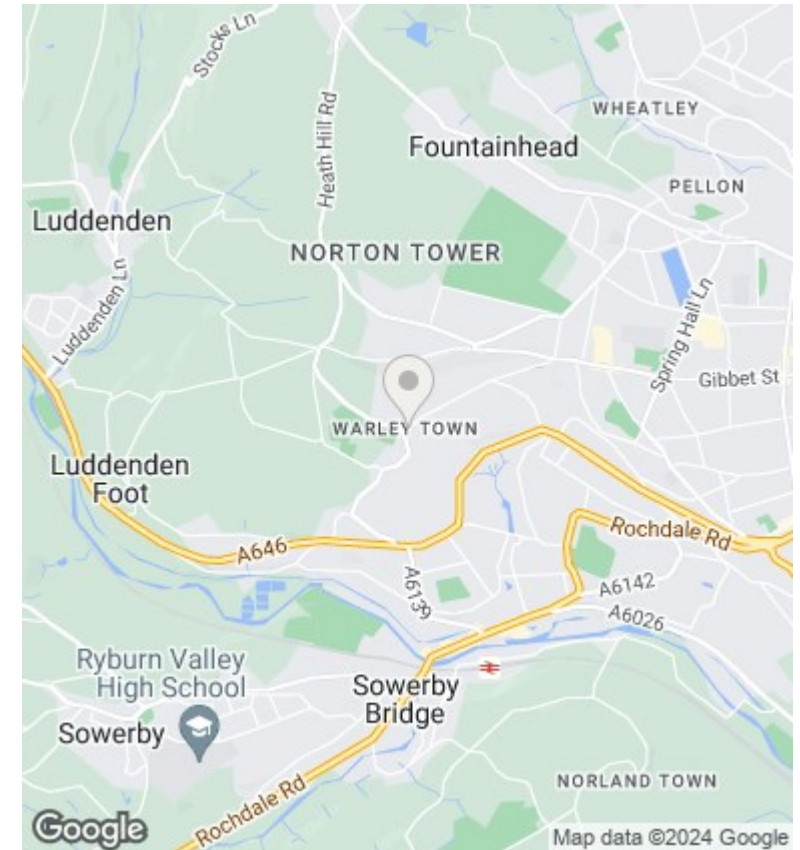

Directions

Viewings

Viewings by arrangement only. Call 01422 349222 to make an appointment.

Council Tax Band

B

EPC Rating:

Energy Efficiency Rating		
	Current	Potential
<i>Very energy efficient - lower running costs</i>		
(92 plus) A		
(81-91) B		
(69-80) C		
(55-68) D		
(39-54) E		
(21-38) F		
(1-20) G		
<i>Not energy efficient - higher running costs</i>		
England & Wales	EU Directive 2002/91/EC	