

Julian Reid



32 Beaumont Court, Upper Clapton Road, London, E5 8BG

A huge, three bedroom flat arranged on the third floor of this 1930's purpose built block located a short walk from Clapton overground station

**Offers in excess of £475,000**  
**Leasehold**

- 906 square feet
- Council Tax Band: B
- EPC Rating: C
- 3 bedrooms
- Large Reception room

A very spacious, three bedroom flat arranged on the third floor of a 1930's purpose built block of flats located in Lower Clapton. The flat offers excellent space in good decorative order and currently provides a good rental income. There are three bedrooms, kitchen, Reception room, bathroom and separate wc. The block is located on Upper Clapton Road, close to the local overground rail station which provides a regular service into Liverpool Street. Both Hackney Downs and Millfields Park are within walking distance and the vibrant selection of shops, bars and restaurants on Lower Clapton Road and Chatsworth Road (market at the weekend) are within easy reach.

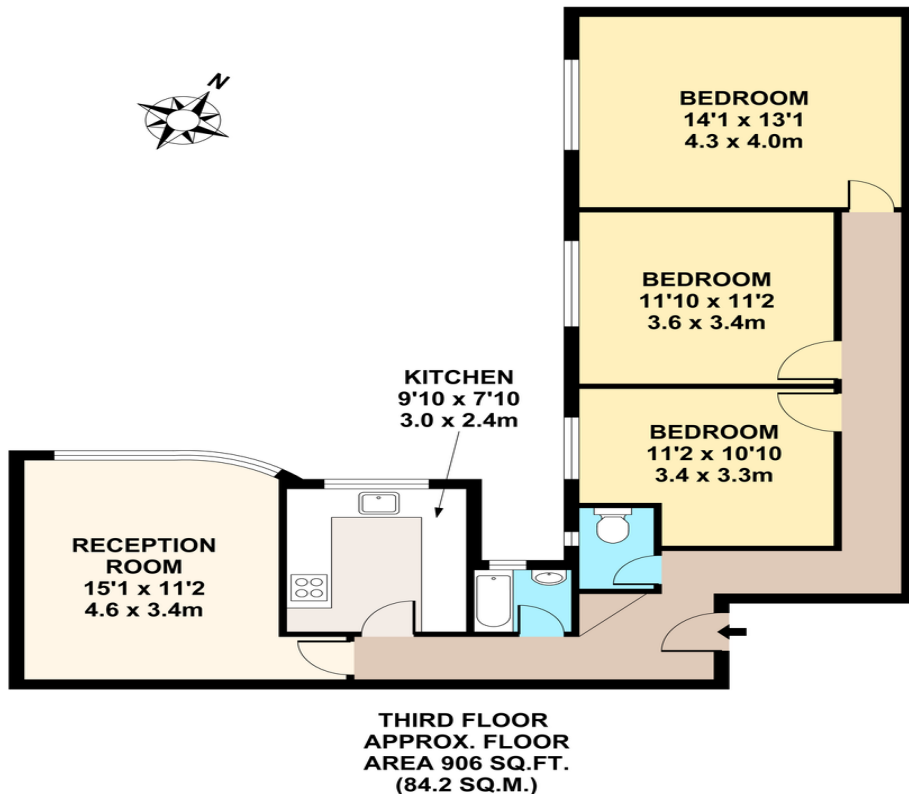

**Important notice:** Julian Reid, their clients and any joint agents give notice that: 1: They are not authorized to make or give representations or warranties in relation to the property either here or elsewhere, either on their own behalf or on behalf of the client or otherwise. They assume no responsibility for any statement that may be made in these particulars. These particulars do not form part of any offer or contract and must not be relied upon as statements or representations of fact. 2: Any areas, measurements or distances are approximate. The text, photographs and plans are for guidance only and are not necessarily comprehensive. It should not be assumed that the property has all necessary planning, building regulation or other consents and Julian Reid have not tested any services, equipment or facilities. Purchasers must satisfy themselves by inspection or otherwise.

