

Fleet Close

Ruislip • Middlesex • HA4 7AZ

Asking Price: £875,000



coopers
est 1986

Fleet Close

Ruislip • Middlesex • HA4 7AZ

A beautifully presented, chain free, four bedroom link-detached residence, located on a sought after residential cul-de-sac in North Ruislip that will immediately impress with both its style and character.

LINK DETACHED

FOUR BEDROOMS

CHAIN FREE

KITCHEN/ DINING

MASTER BEDROOM WITH EN SUITE

FAMILY BATHROOM

EASILY MAINTAINED GARDEN

LARGE GARAGE

OFF STREET PARKING

1773 SQ FT

These particulars are intended as a guide and must not be relied upon as statements of fact. Your attention is drawn to the Important Notice on the last page.





GROUND FLOOR
1204 sq.ft. (111.9 sq.m.) approx.

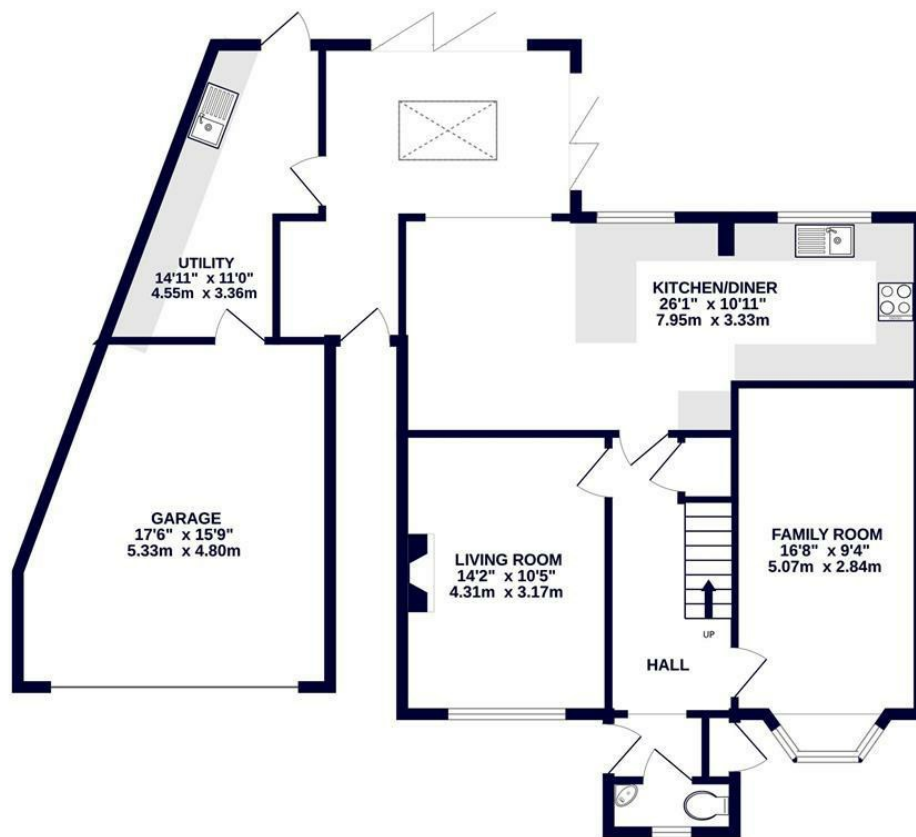

1ST FLOOR
569 sq.ft. (52.9 sq.m.) approx.



coopers
est 1986

TOTAL FLOOR AREA : 1773 sq.ft. (164.8 sq.m.) approx.

Whilst every attempt has been made to ensure the accuracy of the floorplan contained here, measurements of doors, windows, rooms and any other items are approximate and no responsibility is taken for any error, omission or mis-statement. This plan is for illustrative purposes only and should be used as such by any prospective purchaser. The services, systems and appliances shown have not been tested and no guarantee as to their operability or efficiency can be given.
Made with Metropix ©2025



coopers
est 1986

126-128 High Street, Ruislip,
Middlesex, HA4 8LL
ruislipsales@coopersresidential.co.uk

CoopersResidential.co.uk

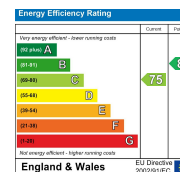

Important Notice: These particulars, whilst believed to be accurate are set out as a general outline only for guidance and do not constitute any part of an offer or contract. Intending purchasers should not rely on them as statements or representation of fact, but must satisfy themselves by inspection or otherwise has the authority to make or give any representation or warranty in respect of the property.