

Ty Carreg Colhugh Street, Llantwit Major
£499,950



Ty Carreg Colhugh Street

Llantwit Major, Llantwit Major

Ty Carrig 'Rock House' Llantwit Major dates back to the late 17th century and includes period features such as a bake oven. It was once an inn (Oddfel...

Council Tax band: F

Tenure: Freehold

EPC Energy Efficiency Rating: D

EPC Environmental Impact Rating: D

- 4 BEDROOMS. 2 RECPS.
- SOUGHT AFTER LOCATION.
- LOG BURNER. PARKING.
- 17TH CENTURY COTTAGE.
- GCH. UTILITY ROOM.
- PERIOD FEATURES. EPC D60.





GROUND FLOOR

Entrance Hallway

Glazed front entrance door. Stairs to first floor. Under stairs cupboard. Doors to sitting room, reception room 2 and kitchen /diner. Radiator. Ceramic floor tiles.

Sitting Room

Dimensions: 13' 11" x 15' 2" max (4.24m x 4.62m). Window to front. Radiator. Fireplace with clear view log burner and tiled hearth. Wood flooring. Door to kitchen/diner.

Reception Room 2

Dimensions: 14' 6" x 13' 1" (4.42m x 3.98m). Window to front. Radiator. Open fire. Wall lights.

Kitchen/Diner

Dimensions: 10' 0" x 20' 0" (3.05m x 6.09m). Window to side. Fully fitted kitchen comprising eye level units, base units with drawers and work surfaces over. Inset sink with mixer tap. Ceramic floor tiles. Space for fridge. Partially tiled walls. Radiator. Eye level oven. inset 5 burner gas hob. Door to utility room.

Utility Room

Dimensions: 10' 0" x 7' 0" (3.05m x 2.13m). Door to rear porch. Double glazed window to rear. Fitted base unit with work surface over and two bowl stainless steel sink with mixer tap. Partially tiled walls. Wall mounted gas Worcester boiler providing the central heating. Ceramic floor tiles.

Rear Porch

Door to rear garden.





FIRST FLOOR

Landing

Doors to bedrooms and family bathroom. Loft access.

Bedroom 1

Dimensions: 13' 11" x 13' 6" inc wardrobe (4.24m x 4.11m). Window to front. Radiator. Built in wardrobe.

Bedroom 2

Dimensions: 15' 1" x 10' 6" (4.59m x 3.20m). Window to side. Radiator. Solid wood floor boards.

Bedroom 3

Dimensions: 14' 1" x 6' 11" (4.29m x 2.11m). Window to front. Radiator. Built in wardrobe.

Bedroom 4

Dimensions: 10' 10" x 11' 4" (3.30m x 3.45m). Window to front. Radiator.

Family Bathroom

Dimensions: 7' 0" x 12' 10" (2.13m x 3.91m). Opaque glazed windows to sides. Low level WC. Panelled bath with telephone style shower and taps. Radiator. Pedestal wash hand basin. Radiator. Shower enclosure with electric mixer shower. Vinyl floor covering. Airing cupboard with hot water tank. Partially tiled walls.

OUTSIDE

Front

Low maintenance enclosed garden area. Parking for one car.

Rear Garden

Dimensions: 7' 8" x 9' 9" (2.34m x 2.97m). An enclosed low maintenance courtyard garden. Sunny westerly aspect.







Ty Carrig

Approximate Gross Internal Area
1625 sq ft - 151 sq m

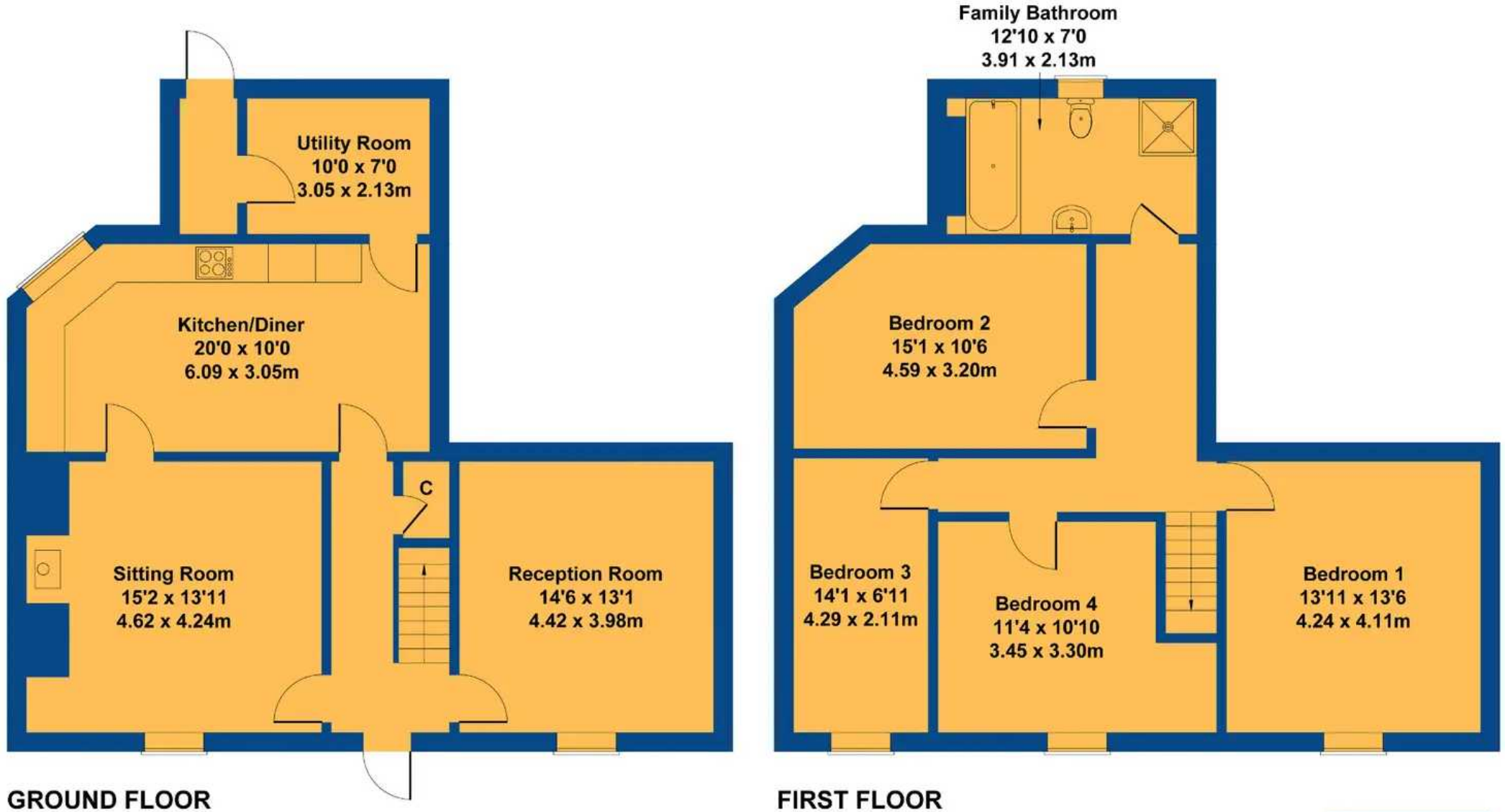

Not to Scale. Produced by The Plan Portal 2022
For Illustrative Purposes Only.



Chris Davies Estate Agents

Chris Davies Estate Agent, Heritage House East Street - CF61 1XY

01446 792020

llantwitmajor@chris-davies.co.uk

www.chris-davies.co.uk/

HELPFUL INFORMATION whilst we try to ensure our sales particulars are complete, accurate and reliable, if there is any point which is particularly important, please ask and we will be happy to check it, including specific information in respect of commuting links, surroundings, noise, views, or condition. For security purposes, applicants who wish to view will need to provide their name, address and telephone number. All measurements are approximate to the widest and longest points. Buyers are advised to instruct a solicitor to obtain verification of tenure and a surveyor to check that appliances, installations and services are in satisfactory condition.