

11 Mallory Close, St. Athan
£115,000



11 Mallory Close

St. Athan, Barry

On the outskirts of this popular development walking distance to St Athan village, Vale of Glamorgan, stands this terraced family home in need of mode...

EPC Energy Efficiency Rating: E

EPC Environmental Impact Rating: E

- 2 BEDROOMS.
- IDEAL FIRST TIME BUY.
- UPVC. GARAGE.
- IN NEED OF MODERNISING.
- NO FORWARD CHAIN.
- MID TERRACED HOME.





GROUND FLOOR

Boiler Room

Please note the property requires a new heating system.

Hallway

Doors to kitchen and sitting room. Understairs cupboard. Stairs to first floor.

WC

Low level WC. UPVC opaque window.

Kitchen

Dimensions: 9' 8" x 9' 4" (2.94m x 2.84m). UPVC window to front. Fitted kitchen comprising eye level units base units and works surface over - with inset stainless steel sink. Space for electric cooker.

Dining Room

Dimensions: 9' 7" x 7' 7" (2.92m x 2.31m). Patio door to rear. Door to kitchen.

Sitting Room

Dimensions: 11' 0" x 13' 8" (3.35m x 4.16m). Door to dining room. UPVC window to rear.



FIRST FLOOR

Landing

Doors to bedrooms, bathroom, and WC. Built in cupboards.

Bedroom 1

Dimensions: 11' 3" x 10' 11" (3.43m x 3.32m). UPVC window to rear. Built in wardrobe.

Bedroom 2

Dimensions: 11' 5" x 10' 6" (3.48m x 3.20m). UPVC window to rear. Built in wardrobe.

Family Bathroom

Dimensions: 5' 7" x 5' 8" (1.70m x 1.73m). Panelled bath. UPVC window to front. Pedestal wash hand basin.



GROUND FLOOR

Boiler Room

Please note the property requires a new heating system.

Hallway

Doors to kitchen and sitting room. Understairs cupboard. Stairs to first floor.

WC

Low level WC. UPVC opaque window.

Kitchen

Dimensions: 9' 8" x 9' 4" (2.94m x 2.84m). UPVC window to front. Fitted kitchen comprising eye level units base units and works surface over - with inset stainless steel sink. Space for electric cooker.

Dining Room

Dimensions: 9' 7" x 7' 7" (2.92m x 2.31m). Patio door to rear. Door to kitchen.

Sitting Room

Dimensions: 11' 0" x 13' 8" (3.35m x 4.16m). Door to dining room. UPVC window to rear.



FIRST FLOOR

Landing

Doors to bedrooms, bathroom, and WC. Built in cupboards.

Bedroom 1

Dimensions: 11' 3" x 10' 11" (3.43m x 3.32m). UPVC window to rear. Built in wardrobe.

Bedroom 2

Dimensions: 11' 5" x 10' 6" (3.48m x 3.20m). UPVC window to rear. Built in wardrobe.

Family Bathroom

Dimensions: 5' 7" x 5' 8" (1.70m x 1.73m). Panelled bath. UPVC window to front. Pedestal wash hand basin.





11 Mallory Close

Approximate Gross Internal Area
872 sq ft - 81 sq m

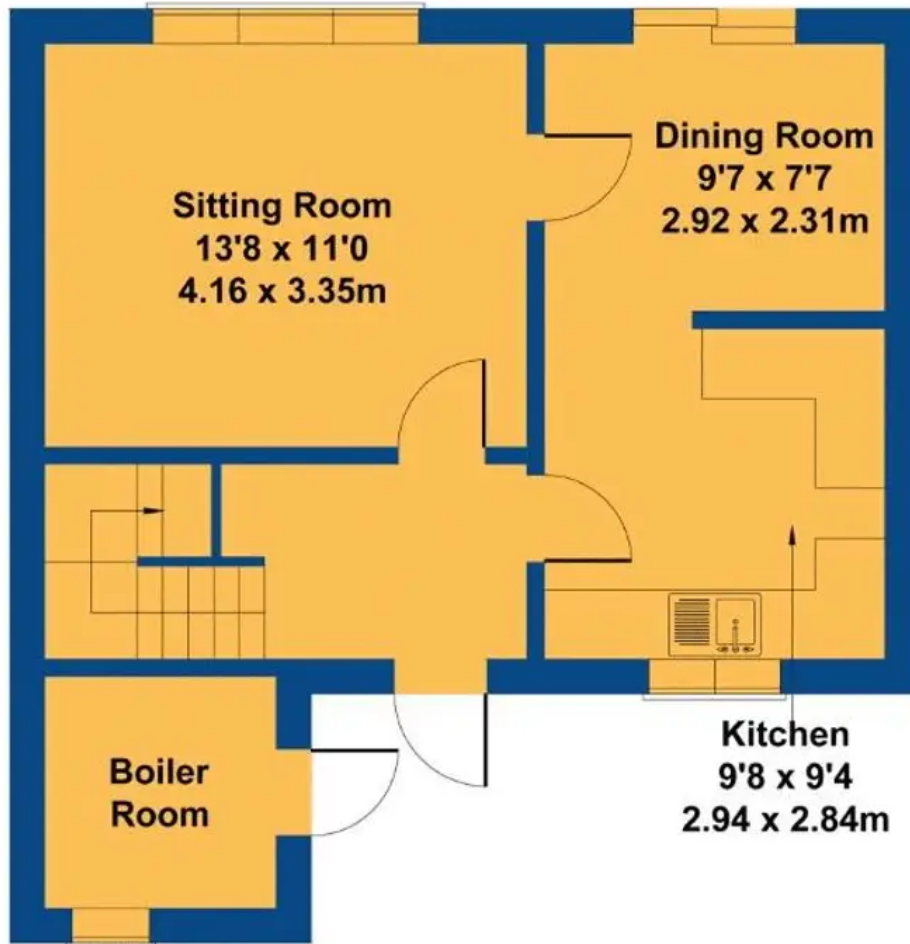

GROUND FLOOR

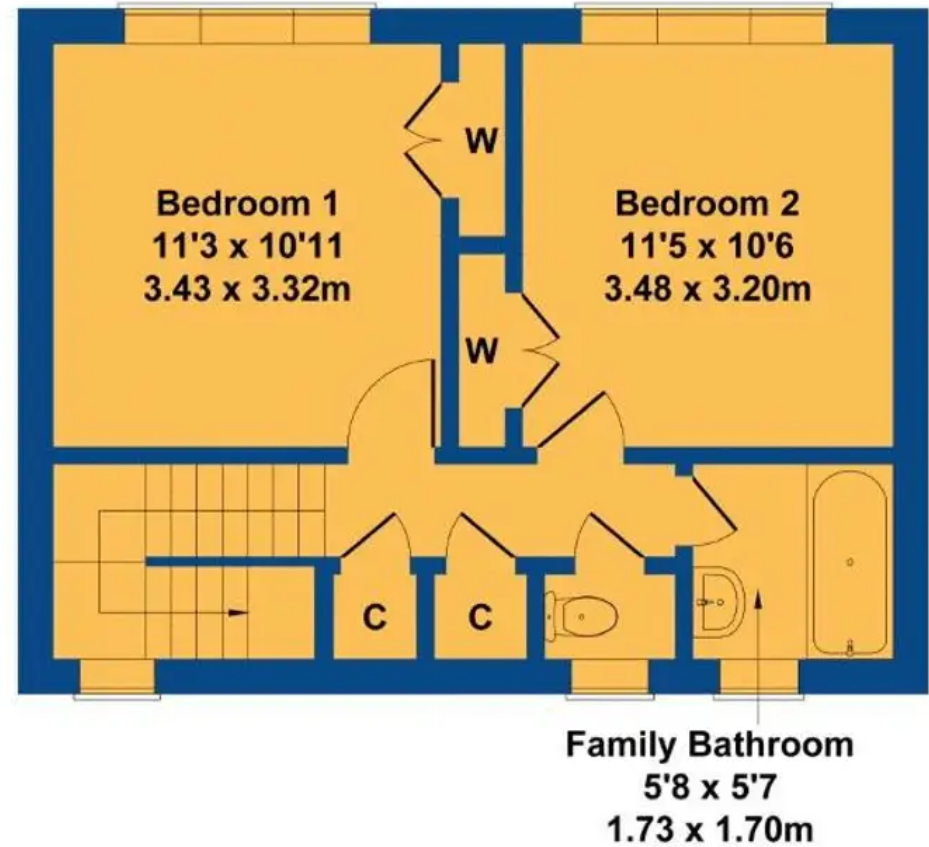

FIRST FLOOR

Not to Scale. Produced by The Plan Portal 2023
For Illustrative Purposes Only.



Chris Davies Estate Agents

Chris Davies Estate Agent, Heritage House East Street - CF61 1XY

01446 792020 • llantwitmajor@chris-davies.co.uk • www.chris-davies.co.uk/

HELPFUL INFORMATION whilst we try to ensure our sales particulars are complete, accurate and reliable, if there is any point which is particularly important, please ask and we will be happy to check it, including specific information in respect of commuting links, surroundings, noise, views, or condition. For security purposes, applicants who wish to view will need to provide their name, address and telephone number. All measurements are approximate to the widest and

You can include any text here. The text can be modified upon generating your brochure.

You can include any text here. The text can be modified upon generating your brochure.