



Chivalry Road
London, SW11

CHESTERTONS





Chestertons are delighted to introduce to the market an immaculate one bedroom Victorian conversion flat situated on a quiet residential road moments from the amenities local to Northcote Road.

The flat is accessed on the second floor with the front door opening into a hallway. Featuring a bright and good sized living space at the front, including a fully fitted kitchen. Along with a modern shower room and good sized double bedroom with built in storage. There is also a large private storage cupboard on the landing outside the flat.

Chivalry Road is fantastically positioned with Wandsworth Common at the end of the street and the bars and bustling cafes of Northcote Road only a short walk away. Clapham Junction offers brilliant transport links in to London and beyond.

- Victorian conversion flat
- One double bedroom
- Situated on a quiet residential road
- Kitchen/breakfast room
- Modern shower room
- Close to Clapham Junction transport links
- Near the bars, restaurants and amenities of Northcote Road
- Moments from the green spaces of Wandsworth Common

Asking Price £375,000

Energy Efficiency Rating		Current	Potential
100-92	A		
81-91	B		
69-80	C	74	74
55-68	D		
39-54	E		
21-38	F		
1-20	G		

Not energy efficient - higher running costs

EU Directive 2002/91/EC

England, Scotland & Wales

Tenure: Leasehold 118 years 5 months

Service Charge: £450

Ground Rent: £300

Local Authority: London Borough of Wandsworth

Council Tax Band: D

Chestertons Battersea & Clapham Sales

6 Battersea Rise

London

SW11 1ED

battersearise@chestertons.co.uk

020 7924 4400

chestertons.co.uk

Chivalry Road, SW11

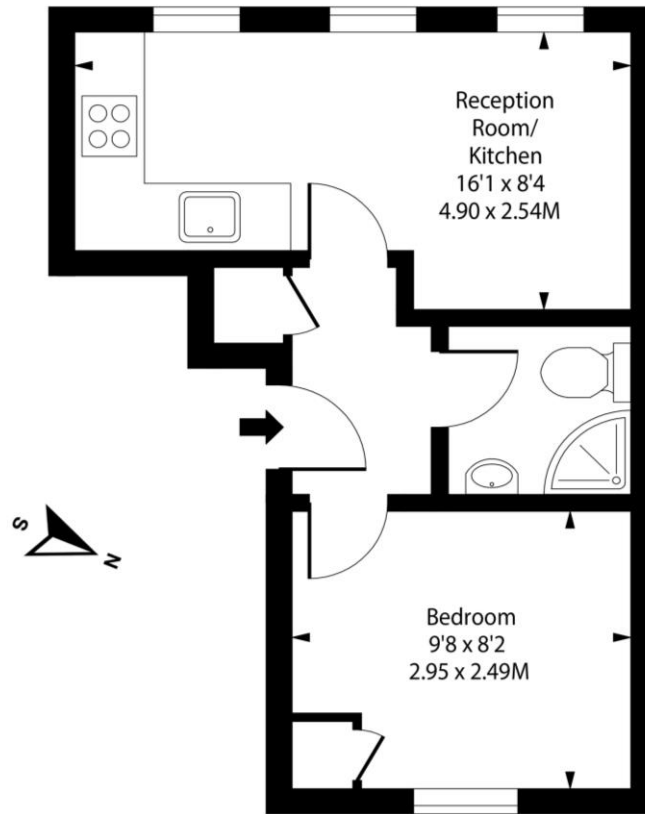

Second Floor

Approx Gross Internal Area **266 Sq Ft - 24.71 Sq M**

Drawn in accordance with IPMS 3B: Residential
Illustration For Identification Purposes Only - Not to Scale
www.homespacestudio.co.uk - Ref. No. 51619



Chesterton UK Services Limited trading as Chestertons for themselves and for the vendor of this property whose agents they are, give notice that (i) these particulars do not constitute any part of an offer or contract, (ii) all statements contained within these particulars are made without responsibility on the part of Chestertons or the vendor, (iii) whilst made in good faith, none of the statements contained within these particulars are to be relied upon as a statement or representation of fact, (iv) any intending purchasers must satisfy themselves by inspection or otherwise as to the correctness of each of the statements contained within these particulars, (v) the vendor does not make or give either Chestertons or any person in their employment any authority to make or give representation or warranty whatsoever in relation to this property. Wide angle lenses may be used. ©Copyright Chestertons | Chesterton UK Services Limited | Registered Office 40 Connaught Street, Hyde Park, London W2 2AB Registered Company Number 05334580.



This paper is
100% recyclable