



THE MOUNT

NEWFIELD MAINS ROAD, DUNDONALD

www.corumproperty.co.uk





5 | BEDROOMS

3 | BATHROOMS

2 | PUBLIC ROOMS

An impressive country house in an idyllic position with a flexible layout over two levels and set in extensive gardens close to the village of Dundonald.

The Mount is a rarely available country house which has been upgraded and modernised by the current owner and is particularly suited to the family market with a flexible layout of seven principal apartments arranged over two levels.

Features and benefits of the property include generous room proportions, modern fitted kitchen, double glazing, quality five piece bathroom and separate three piece shower room, double glazing, fresh carpets, neutral decoration, oil central heating, fitted wardrobes and extensive storage.

In summary the accommodation extends to, on the ground floor, an entrance porch, broad and welcoming reception hallway, formal lounge with wood burner and picture window overlooking the gardens, dining room, kitchen split into two areas providing space for informal dining, useful utility room and rear hall with door to the rear garden, two downstairs bedrooms and a three piece shower room. Upstairs there are three further double bedrooms (one with three piece en-suite shower room). Completing the accommodation is a spacious bathroom with five piece suite.

Externally the property is approached via gated entry onto a sweeping driveway which culminates in ample parking and a single detached garage which is currently used as a workshop. The gardens are predominantly laid to lawn with mature trees including cherry blossoms flanking the driveway and well stocked shrubbery borders. Accessed from the rear hall there is a separate enclosed patio garden. Included in the sale will be the summerhouse.







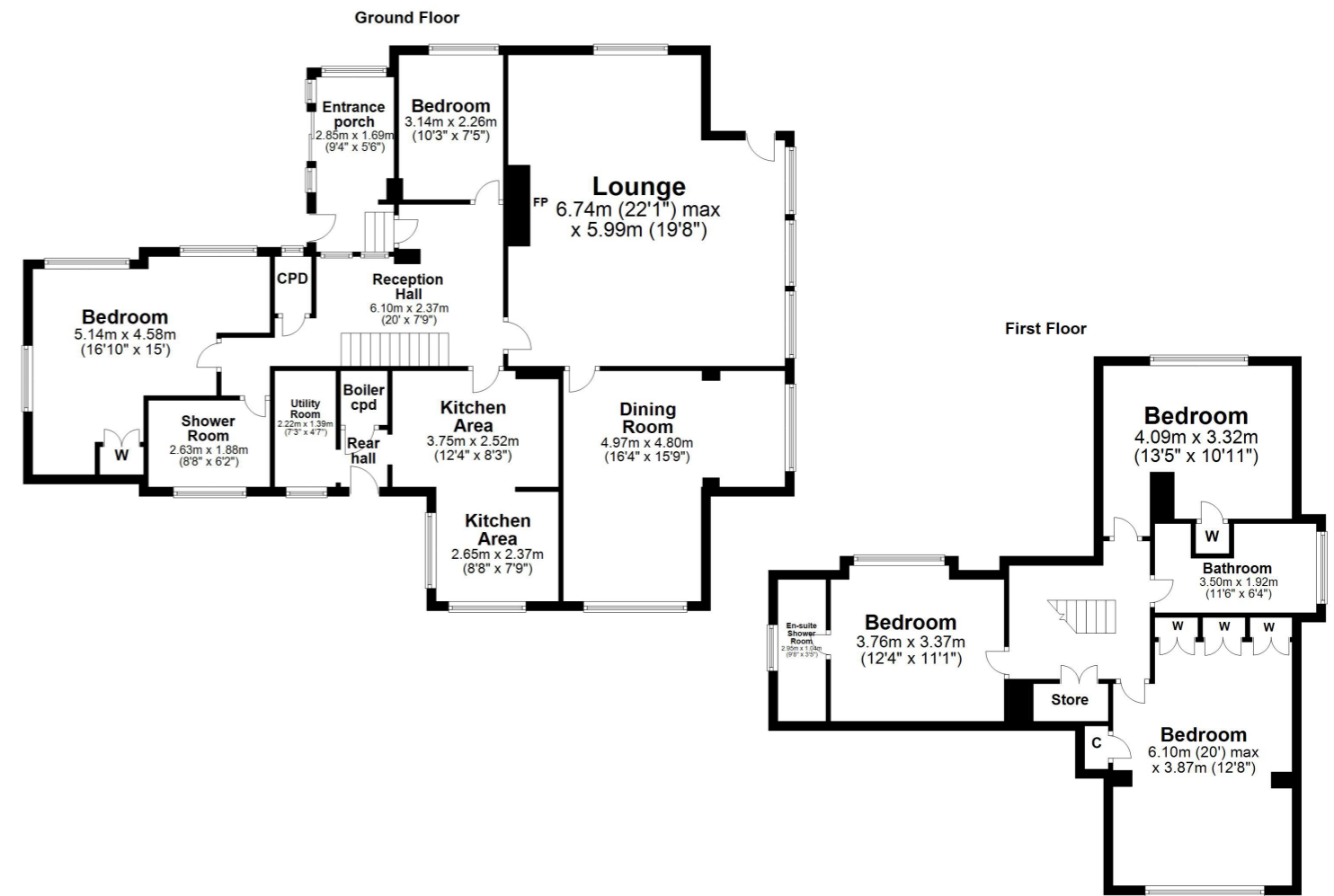

The Mount enjoys an enviable position which is slightly elevated creating scenic views including across to Dundonald Castle. Situated just outside the bustling village of Dundonald the property is within close proximity to a wide range of amenities including primary schooling and shops. For commuters the A77/M77 is around one mile distant and provides swift commuting south to Ayr and north to Glasgow.

TR1844 | Sat Nav: The Mount, Newfield Mains Road, Dundonald, KA2 9BH

For the full home report visit www.corumproperty.co.uk

* All measurements and distances are approximate Floorplans are for illustration purposes and may not be to scale.



WE'RE **SOLD** ON
YOUR FUTURE



c o r u m

Corum Troon
29 Portland Street, Troon, KA10 6AA

Tel: 01292 310 010

Email: troon@corumproperty.co.uk

www.corumproperty.co.uk