

Heath Road
Twickenham
TW1 4BW

£1,100 PCM

ChaseBuchanan

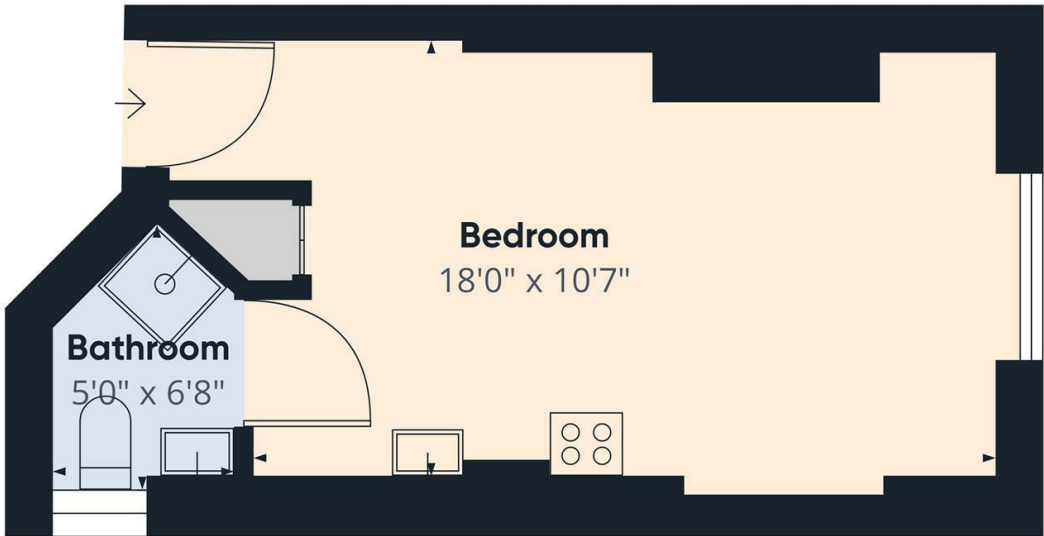



Approximate total area⁽¹⁾
219.15 ft²

(1) Excluding balconies and terraces

While every attempt has been made to ensure accuracy, all measurements are approximate, not to scale. This floor plan is for illustrative purposes only.

GIRAFFE360

- First floor
- Separate bathroom
- Central location
- Council Tax Band B
- Studio apartment
- Modern kitchen
- EPC E

Centrally located studio flat in Twickenham.

The property has been finished to a good standard with a fitted kitchen, bathroom suite, separate W/C, sitting room/double bedroom and presented in good condition.

Located on a popular road just off the high street, the property is close to numerous bars, restaurants, and shops, with Twickenham station only 0.4 miles away. Heath Road offers convenient access to the high street, station, and river walks, and there are regular buses to Richmond (District line tube), Kingston, and a short drive to the M3, providing good access to the M25 and M4.

Chase Buchanan are bonded members of ARLA Propertymark.

For more information or to book a viewing, please contact:

020 8744 2111

ChaseBuchanan

122 Heath Road, Twickenham, Middlesex, TW1 4BW

Energy Efficiency Rating	Current	Potential
Very energy efficient - lower running costs		
92-100 A		
81-91 B		
69-80 C		
55-68 D		
39-54 E		
21-38 F		
1-20 G		

Environmental Impact (CO ₂) Rating	Current	Potential
Very environmentally friendly - lower CO ₂ emissions		
35-47 A		
23-34 B		
15-22 C		
9-14 D		
4-8 E		
1-3 F		
0 G		

Care has been taken in the preparation of these particulars, however, their accuracy is not guaranteed and they do not form part of any contract. Measurements stated must be considered maximum.